

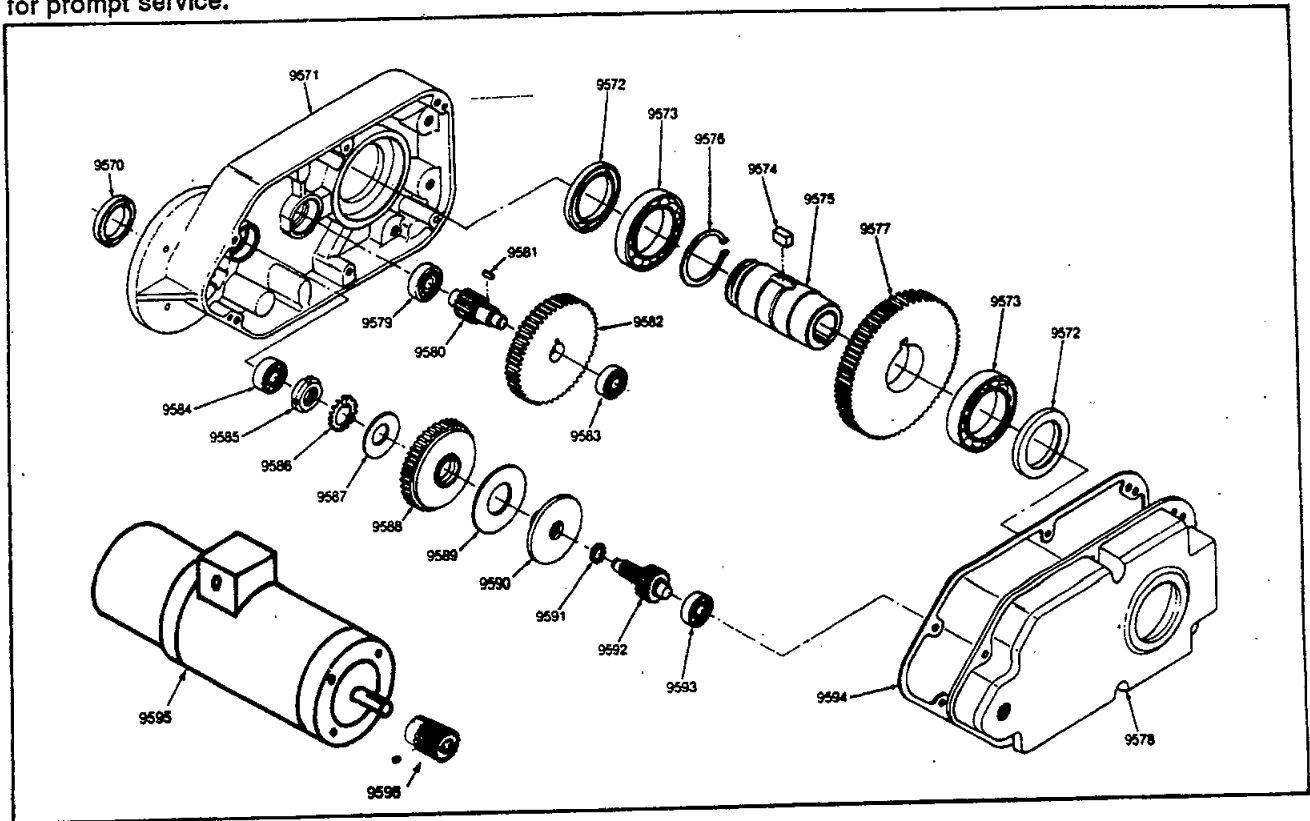

This is your operation and maintenance manual for your R&M Materials Handling, Inc. TR3 gearmotor. A copy of this manual was included with the shipment.  
Please specify the serial # and part reference # for prompt service.

SERIAL # \_\_\_\_\_  
CATALOG # \_\_\_\_\_  
MOTOR H.P. \_\_\_\_\_ @ \_\_\_\_\_ RPM  
CURRENT \_\_\_\_\_ VOLT \_\_\_\_\_ PH \_\_\_\_\_ CYCLE



**TR 3 MOTORREDUCER GEARCASE**

REFERENCE NUMBER	PART DESCRIPTION	REFERENCE NUMBER	PART DESCRIPTION
9570	OIL SEAL	9584	BALL BEARING
9571	GEARCASE	9585	BEARING LOCK NUT
9572	OIL SEAL	9586	BEARING LOCK WASHER
9573	BALL BEARING	9587	BEVELLED WASHER
9574	KEY	9588	SHOCK CLUTCH
9575	DRIVE SHAFT	9589	FRICITION DISC
9576	SNAP RING	9590	SHOCK CLUTCH DISC
9577	DRIVE GEAR	9591	SNAP RING
9578	GEARCASE COVER	9592	CLUTCH PINION
9579	BALL BEARING	9593	BALL BEARING
9580	INTERMEDIATE PINION	9594	GEARCASE GASKET
9581	KEY	9595	MOTOR
9582	INTERMEDIATE GEAR	9596	MOTOR PINION
9583	BALL BEARING		

DRIVE SERIAL NUMBER MUST BE FURNISHED IN ADDITION TO PART REFERENCE NUMBER

## BRAKE

**"E" FRAME ASSEM.**

**ARMATURE PLATE**

**AIR GAP**

**A**

**B**

**BOTH BRAKE STUDS TO BE HELD IN PLACE BY APPLYING A COAT OF GRADE "A" LOCTITE SEALANT TO THREADS IN FINAL ASSEMBLY.**

**MOVE THIS DIRECTION TO INCREASE TORQUE AND PROVIDE QUICKER STOP**

**MOVE THIS DIRECTION TO REDUCE TORQUE AND PROVIDE SMOOTHER STOP**

All brakes are set at the factory for average conditions based on the capacity and speed. You may adjust the torque to suit your particular application.

To adjust brake torque-compress spring to the required level by adjusting nut "A", lock in place with jam nut.

To adjust brake for lining wear, set air gap at  $1/32"$  (.031") by adjusting nut "B". Lock armature plate securely in place with jam nut.

**IMPORTANT:** Recheck air gap to make sure at least .031" air gap is present. For maximum life and performance from brake, adjustments should be made when air gap exceeds  $1/16"$  due to friction disc wear. Disc should be replaced when thickness of disc is reduced to  $1/8"$ .

## MOUNTING

The R&M Materials Handling, Inc. crane drive may be mounted in either a vertical or horizontal position.

## CLUTCH ADJUSTMENT

The drive train is equipped with an override clutch to protect against potentially damaging impact loads. If excessive slips develop during normal operations, the clutch may be tightened. To tighten clutch remove the clutch assembly from the gear case. Tighten the bearing locknut (Fig. 415-1, Part No. 9585) all the way. Then back off locknut  $1/4$  turn. Relock in place with bearing lock washer (Fig. 415-1, Part No. 9586).

**NOTE:** Vent plug must be installed prior to start-up.

## LUBRICATION

A good commercial grade gear lube is recommended for use as follows:

For ambient temperatures of  $-20^{\circ}$  to  $40^{\circ}\text{F}$  use an 80 weight lube.

For ambient temperatures of  $40^{\circ}$  to  $120^{\circ}\text{F}$  use a 90 weight lube.

Vertical position use  $1\frac{1}{2}$  quarts.

Horizontal position use 2 quarts.

**NOTE:** Before placing the drive unit in operation, oil level must be checked and filled.

**CHECKING-PLUG ON REVERSE SIDE**

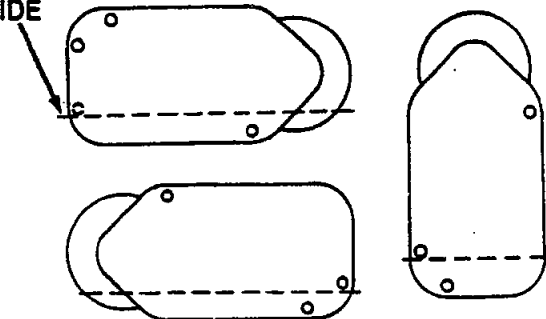

OIL LEVEL INDICATED BY HEAVY DASHED LINE