

13 Flashing light assembly

13.1 Flashing light assembly, top running end carriages

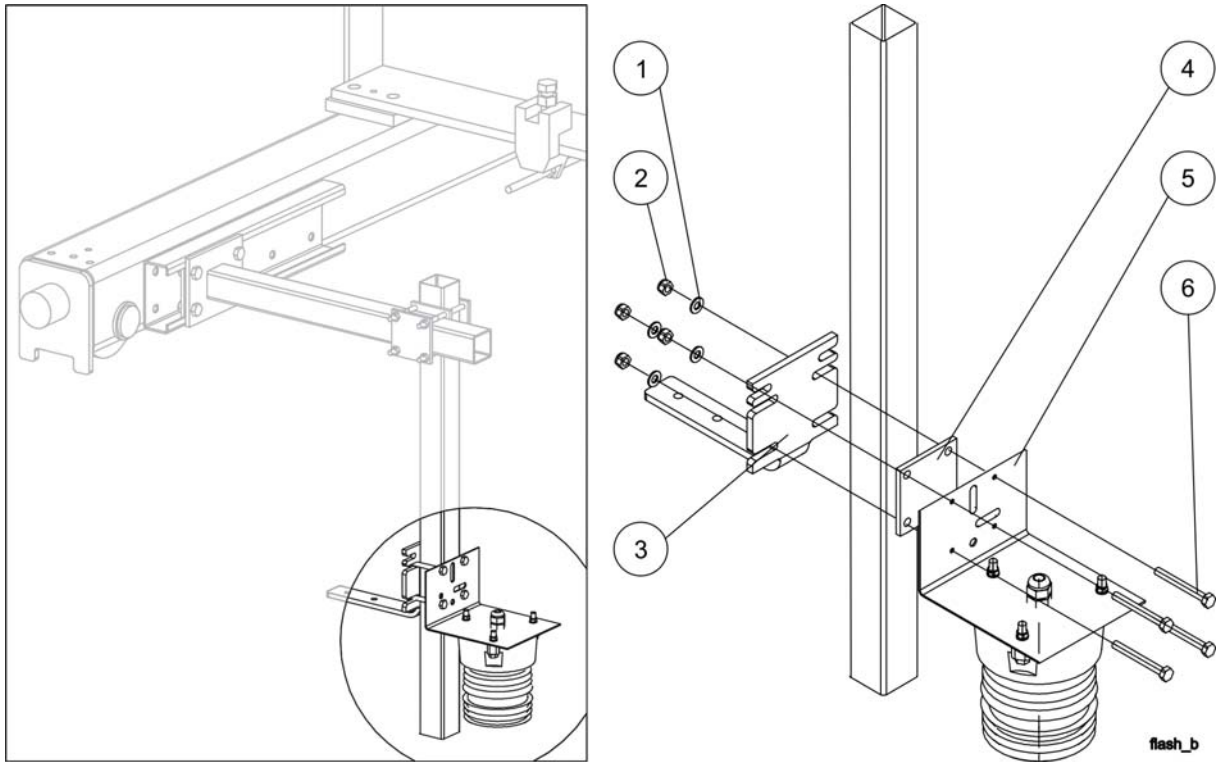

Pos.	Name	Specification	Amount
1	Washer	DIN125-A8-A3G	8
2	Nut	DIN985-M8-8-A3G	4
3	Crane towing arm	CQP-L195W150H135	1
4	Plate	CQP-L80W80H6	1
5	Fixing plate	EN10025-S235JR-2MM 170X102	1
6	Screw	DIN931-M8x80-8.8-A3G	4

- In conductor rail type of power supply the towing arm (part number 3) is not needed. Instead of towing arm, use the plate (part number 4).

13.2 Flashing light assembly, underrunning end carriages

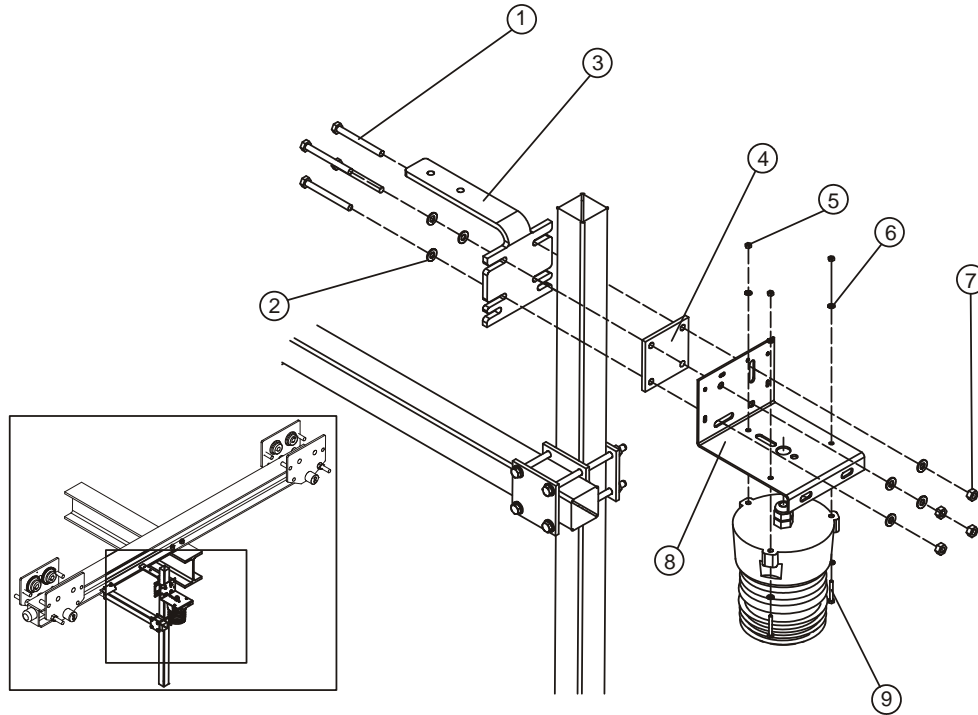

Pos.	Name	Specification	Amount
1	Screw	DIN931-M8X80-8.8-A3G	4
2	Washer	DIN125-A8-A3G	8
3	Towing arm		1
4	Fixing plate	CQP-L80W80H6	1
5	Nut	DIN934-M4-8-A3G	3
6	Washer	DIN125-A4-A3G	6
7	Nut	DIN985-M8-8-A3G	4
8	Fixing plate	CQ-L170W128H140T2.5	1
9	Screw	DIN933-M4X30-8.8-A3G	3

- In conductor rail type of power supply the towing arm (part number 3) is not needed. Instead of towing arm, use the plate (part number 4).