

FOOT MOUNT, 6 PART SINGLE
 Hoist type:
 SX4 061...F0

SI-50Hz

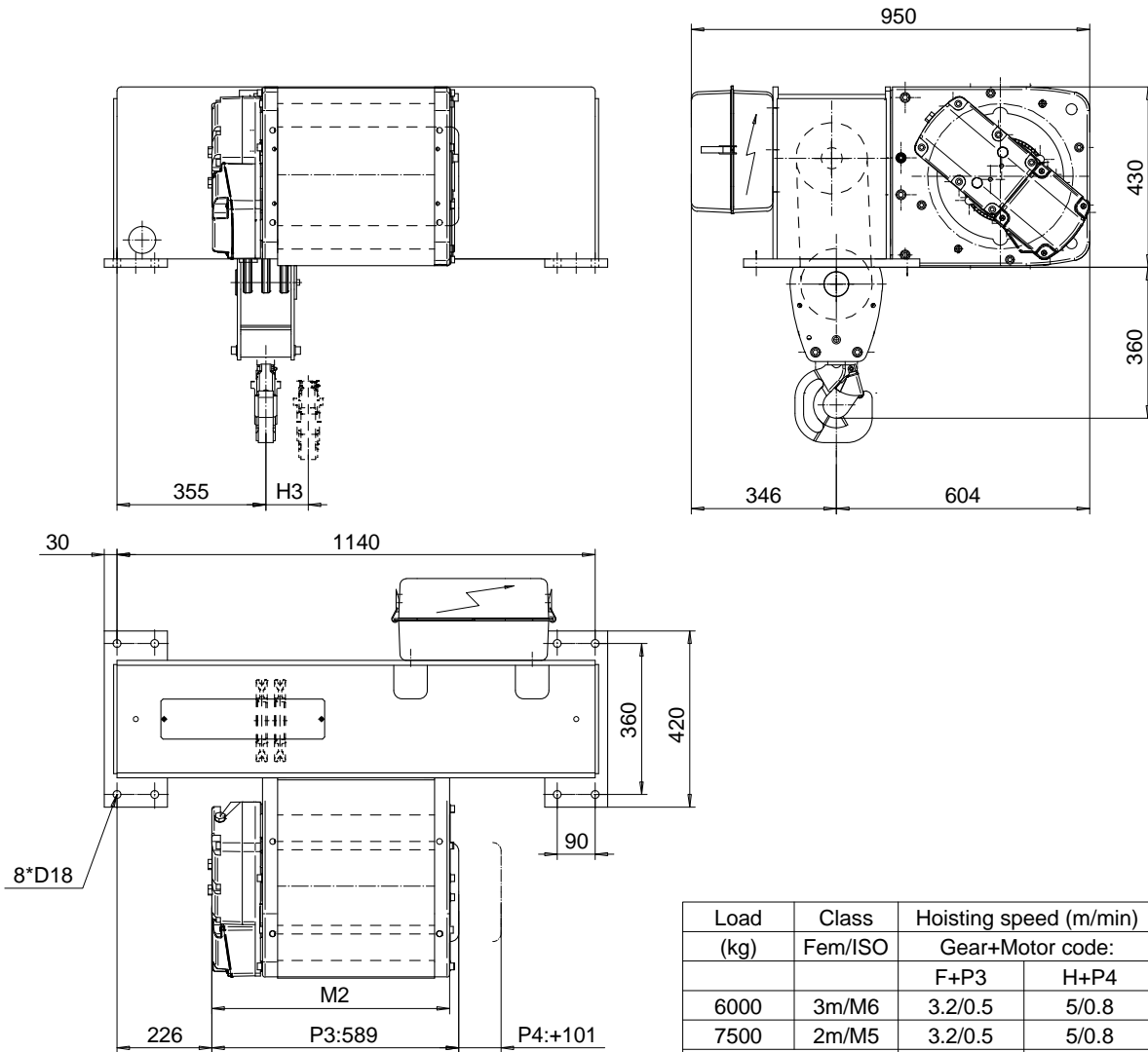

Load (kg)	Class Fem/ISO	Hoisting speed (m/min)	
		Gear+Motor code:	
		F+P3	H+P4
6000	3m/M6	3.2/0.5	5/0.8
7500	2m/M5	3.2/0.5	5/0.8
+ weight (kg):		-	20

HOL (m)	Length code	M2 (mm)	H3 (mm)	Weight (kg)
6	C	567	49	350
8	D	667	65	365
10	E	787	85	380

This document is the absolute property of R&M Materials Handling, Inc. This document must not be copied without the written permission of R&M Materials Handling, Inc. The contents thereof must not be disclosed to a third party nor be used for any unauthorized purpose. Contravention will be prosecuted.

CSDPAL	CSDPAL	Appd	Ref Drawing	QB-F-06
Design	2002-08-28	Date	HOIST: FIXED	
SLEQREN01	Owner Dept	6 ROPE FALLS		1:1, 7:5
R&M	R&M MATERIALS HANDLING, INC.	D002098-A		3