

FOOT MOUNT, 6 PART SINGLE

Hoist type:

SX6 061...F0

SI-50Hz

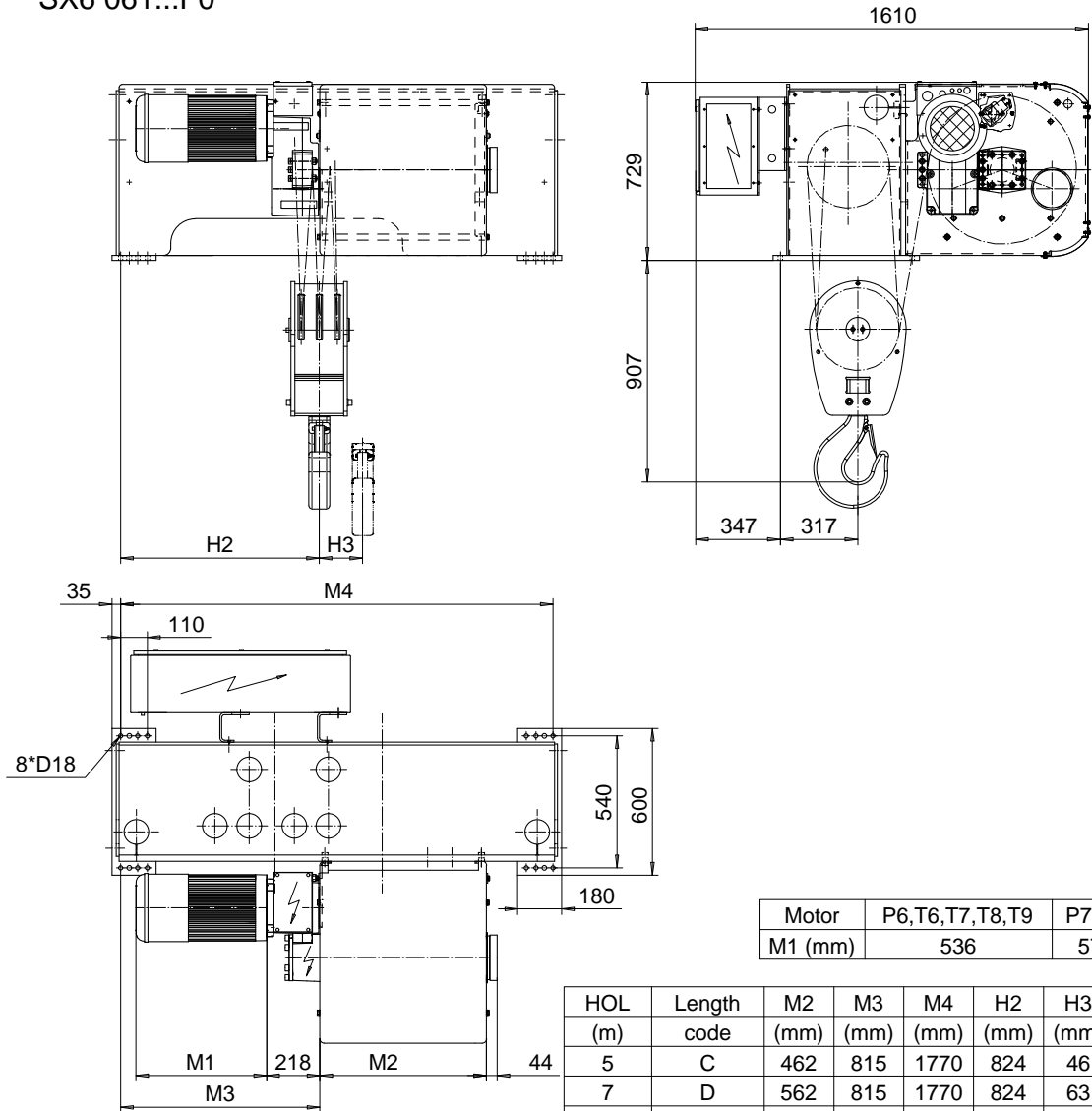

Motor	P6,T6,T7,T8,T9	P7,TA	P8
M1 (mm)	536	576	711

HOL (m)	Length code	M2 (mm)	M3 (mm)	M4 (mm)	H2 (mm)	H3 (mm)	Weight (kg)
5	C	462	815	1770	824	46	1450
7	D	562	815	1770	824	63	1475
9	E	682	815	1770	824	84	1525
12	F	832	475	1770	487	107	1575
15.5	G	1022	475	1770	487	140	1675
20	H	1272	469	2580	481	182	1950
26.5	J	1622	469	2580	481	240	2050
32	K	1922	469	2580	481	289	2150

Load (kg)	Class	Hoisting motor					
		Hoisting speed (m/min): Gear code					
	Fem/ISO	2.5/0.4 : E	3.2/0.5 : F	4/0.7 : G	5 : H	6.3 : J	
20000	3m/M6	P6,T6	P6,T6	P7,T7	T8	T9	
25000	2m/M5	P6,T6	P6,T6	P7,T7	T8	T9	
30000	1Am/M4	P6,T6	P7,T7	P8,T8	T9	TA	

ETTPAL Design	ETTPAL Chd	Appd	Ref Drawing	QD-F-06
2002-09-02 Date	HOIST; FIXED			1 of 13 Folder
SLEQDOCV Owner Dept	6 ROPE FALLS			
R&M R&M MATERIALS HANDLING, INC. HOIST & CRANE PRODUCTS SHEPHERD, OHIO	D002145-A			Issue 6

This document is the absolute property of R&M Materials Handling, Inc. This document must not be copied without the written permission of R&M Materials Handling, Inc. The contents thereof must not be disclosed to a third party nor be used for any unauthorized purpose. Contravention will be prosecuted.