

**FOOT MOUNT, 6 PART SINGLE**  
**Hoist type:**  
**SX4 061...F0**

SI-60Hz

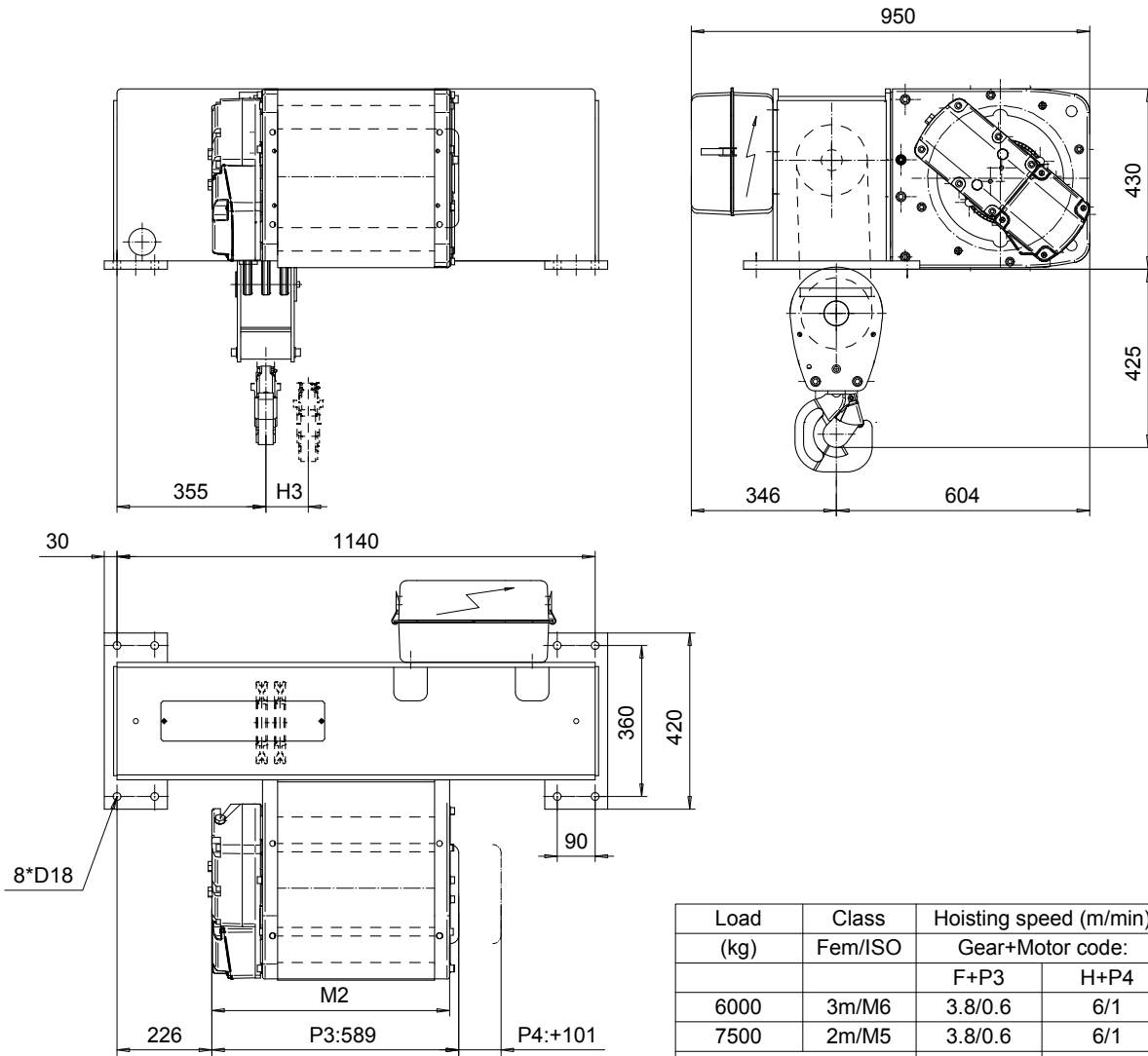

Load (kg)	Class Fem/ISO	Hoisting speed (m/min)	
		Gear+Motor code:	
		F+P3	H+P4
6000	3m/M6	3.8/0.6	6/1
7500	2m/M5	3.8/0.6	6/1
+ weight (kg):		-	20

HOL (m)	Length code	M2 (mm)	H3 (mm)	Weight (kg)
6	C	567	49	350
8	D	667	65	365
10	E	787	85	380

This document is the absolute property of R&M Materials Handling, Inc. This document must not be copied without the written permission of R&M Materials Handling, Inc. The contents thereof must not be disclosed to a third party nor be used for any unauthorized purpose. Contravention will be prosecuted.

CSDPAL Design	CSDPAL Title	Appd.	Ref. Drawing	QB-F-06
2002-08-28 Date	HOIST; FIXED			1:1-7.5 Pictorial
SLEQWENG1 Desain Dept	6 ROPE FALLS			
R&M MATERIALS HANDLING, INC. R&M LOGO PRODUCTS SHEWAN/UMC	D002098-A			3