

FOOT MOUNT, 4 PART DOUBLE
Hoist type:
SX6 042...F0

SI-60Hz

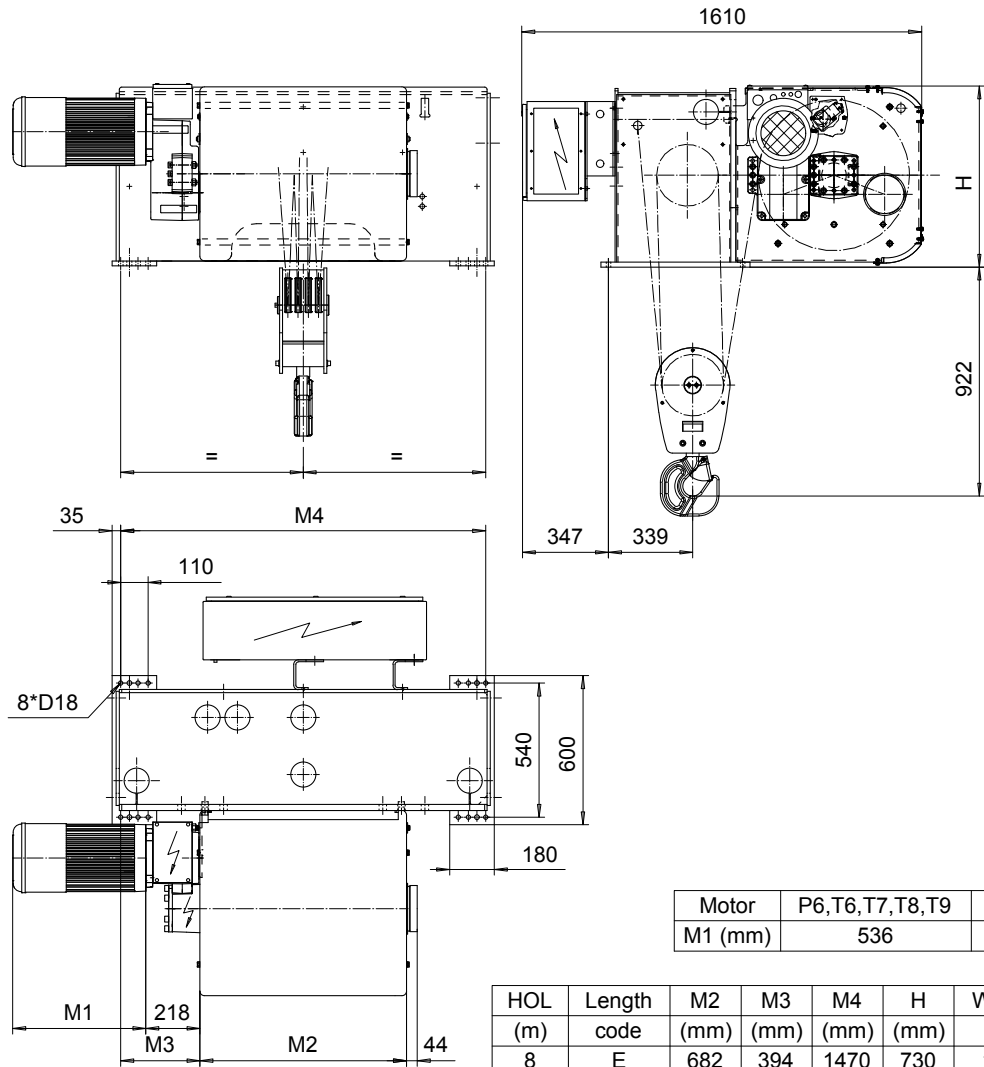

Motor	P6,T6,T7,T8,T9	P7,TA	P8
M1 (mm)	536	576	711

HOL (m)	Length code	M2 (mm)	M3 (mm)	M4 (mm)	H (mm)	Weight (kg)
8	E	682	394	1470	730	1450
11	F	832	319	1470	730	1500
14.5	G	1022	224	1470	730	1550
19.5	H	1272	599	2470	730	1875
26	J	1622	424	2470	730	1975
31.5	K	1922	274	2470	730	2075
38.5	L	2272	449	3170	830	2525
43	M	2522	324	3170	830	2625
49	N	2822	174	3170	830	2725

Load (kg)	Class Fem/ISO	Hoisting motor				
		Hoisting speed (m/min): Gear code				
		4.8/0.8 : E	6/1 : F	7.5/1.3 : G	9.5 : H	12 : J
12500	3m/M6	P6,T6	P6,T6	P7,T7	T8	T9
16000	2m/M5	P6,T6	P6,T6	P7,T7	T8	T9
20000	1Am/M4	P6,T6	P7,T7	P8,T8	T9	TA

ETFPAL Design 2002-09-03 Date	ETFPAL Chd Appd	Ref Drawing	QD-F-24
SLEQDCV Owner Dept	HOIST; FIXED 2x4 ROPE FALLS		1 of 15 Folder
R&M R&M MATERIALS HANDLING, INC. HOIST & CRANE PRODUCTS SHERBOURNE, ONT.	D002155-A		Issue 6

This document is the absolute property of R&M Materials Handling, Inc. This document must not be copied without the written permission of R&M Materials Handling, Inc. The contents thereof must not be disclosed to a third party nor be used for any unauthorized purpose. Contravention will be prosecuted.