

FOOT MOUNT, 8 PART SINGLE

Hoist type:

SX6 081...F0

SI-60Hz

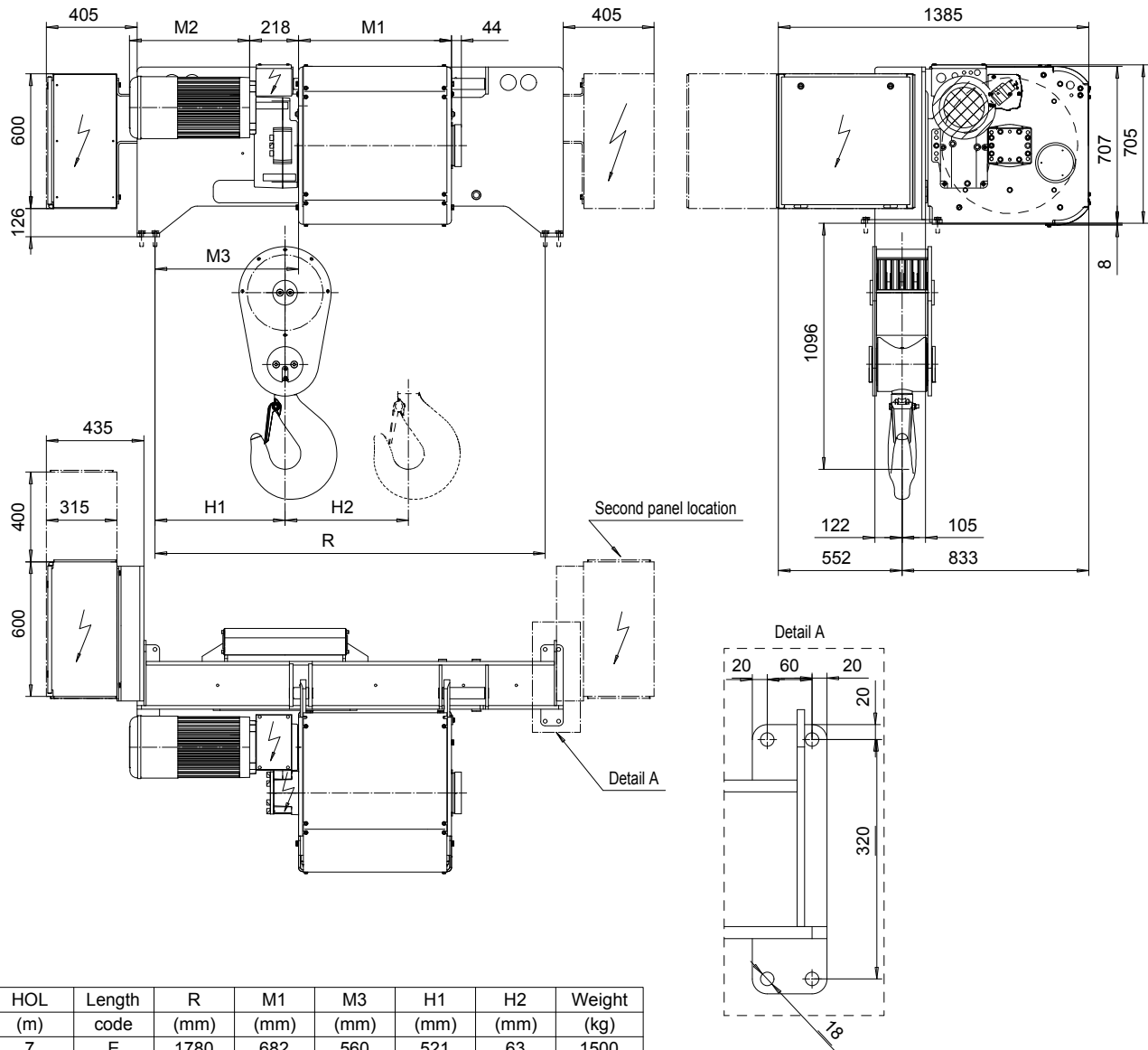

HOL	Length	R	M1	M3	H1	H2	Weight
(m)	code	(mm)	(mm)	(mm)	(mm)	(mm)	(kg)
7	E	1780	682	560	521	63	1500
9	F	1780	832	560	521	81	1600
11.5	G	2290	1022	640	601	105	1700
15	H	2290	1272	640	601	137	1800
20	J	2699	1622	810	771	180	2100
24	K	2699	1922	810	771	217	2200

Motor	P6,T6,T7,T8,T9	P7,TA	P8
M2 (mm)	536	576	711
Wgt (kg)	81	106	106

Load (kg)	Class Fem/ISO	Hoisting motor					
		Hoisting speed (m/min): Gear code					
		2.4/0.4: E	3/0.5: F	3.8/0.6: G	3.8: G	4.8: H	6: J
32000	2m/M5	P6,T6	P7,T7	----	T8	T9	TA
40000	1Am/M4	P6,T6	P7,T7	P8	T8	T9	TA

Hoist weight calculated with P6 motor weight.

This document is the absolute property of R&M Materials Handling, Inc. This document must not be copied without the written permission of R&M Materials Handling, Inc. The contents thereof must not be disclosed to a third party nor be used for any unauthorized purpose. Contravention will be prosecuted.

ETTPAL Design 2002-09-02 Date SLEODOCV Owner Dept	ETTPAL Chd Appd Ref Drawing	QD-F-08
R&M MATERIALS HANDLING INC.	8M MATERIALS HANDLING INC HOIST & CRANE PRODUCTS SPRINGFIELD, OHIO	HOIST; FIXED 8 ROPE FALLS Folder
D006939-A		Issue 1/2011