

FOOT MOUNT, 2 PART DOUBLE
Hoist type:
SX6 022...F0

US-60Hz

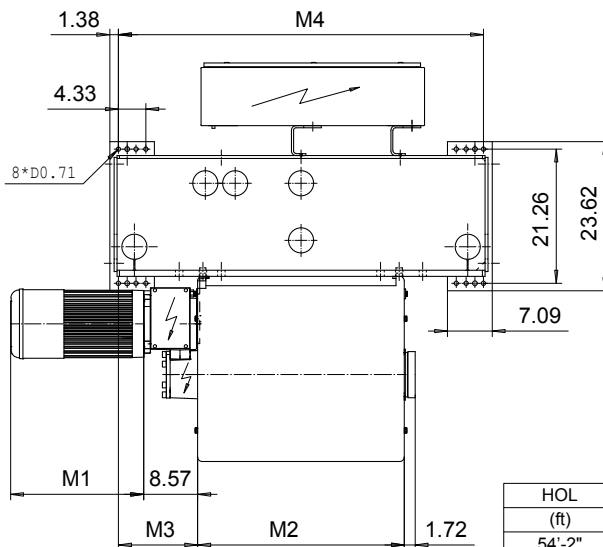
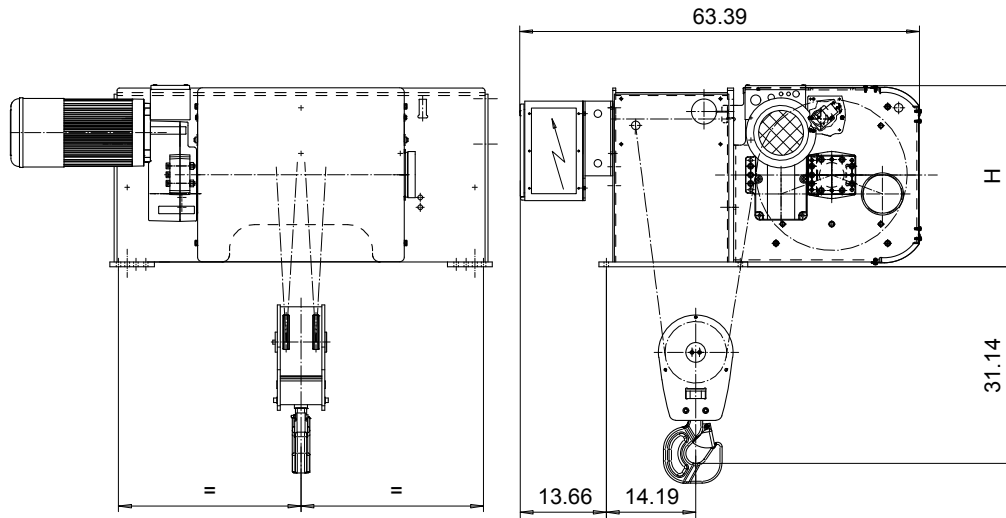

Motor	P6,T6,T7,T8,T9	P7,TA	P8
M1 (inch)	21.10	22.67	27.99

HOL (ft)	Length code	M2 (inch)	M3 (inch)	M4 (inch)	H (inch)	Weight (lb)
54'-2"	E	26.85	15.51	57.87	28.74	2800
72'-2"	F	32.75	12.56	57.87	28.74	2900
96'-9"	G	40.23	8.82	57.87	28.74	3000
127'-11"	H	50.07	23.58	97.24	28.74	3650
170'-7"	J	63.85	16.69	97.24	28.74	3850
208'-4"	K	75.66	10.79	97.24	28.74	4050
252'-7"	L	89.44	17.68	124.80	32.68	4950
283'-10"	M	99.29	12.76	124.80	32.68	5150
321'-6"	N	111.10	6.85	124.80	32.68	5350

Load (TON)	Class ASME	Hoisting motor				
		Hoisting speed (ft/min): Gear code				
		30/4.9 : E	40/6.7 : F	50/7.8 : G	60 : H	80 : J
6	H4+	P6,T6	P6,T6	P7,T7	T8	T9
7 1/2	H4	P6,T6	P6,T6	P7,T7	T8	T9
10	H3	P6,T6	P7,T7	P8,T8	T9	TA

ETFPAL	ETFPAL	App'd	Ref Drawing	QD-F-22
Design	2002-09-02	Date	HOIST; FIXED	
SLEQDOCV	Owner Dept	2x2 ROPE FALLS		1 of 15
R&M	S&W MATERIALS HANDLING, INC.	D002152-A		Issue 6

This document is the absolute property of R&M Materials Handling, Inc. This document must not be copied without the written permission of R&M Materials Handling, Inc. The contents thereof must not be disclosed to a third party nor be used for any unauthorized purpose. Contravention will be prosecuted.