

FOOT MOUNT, 4 PART SINGLE
Hoist type:
SX6 041...F0

US-60Hz

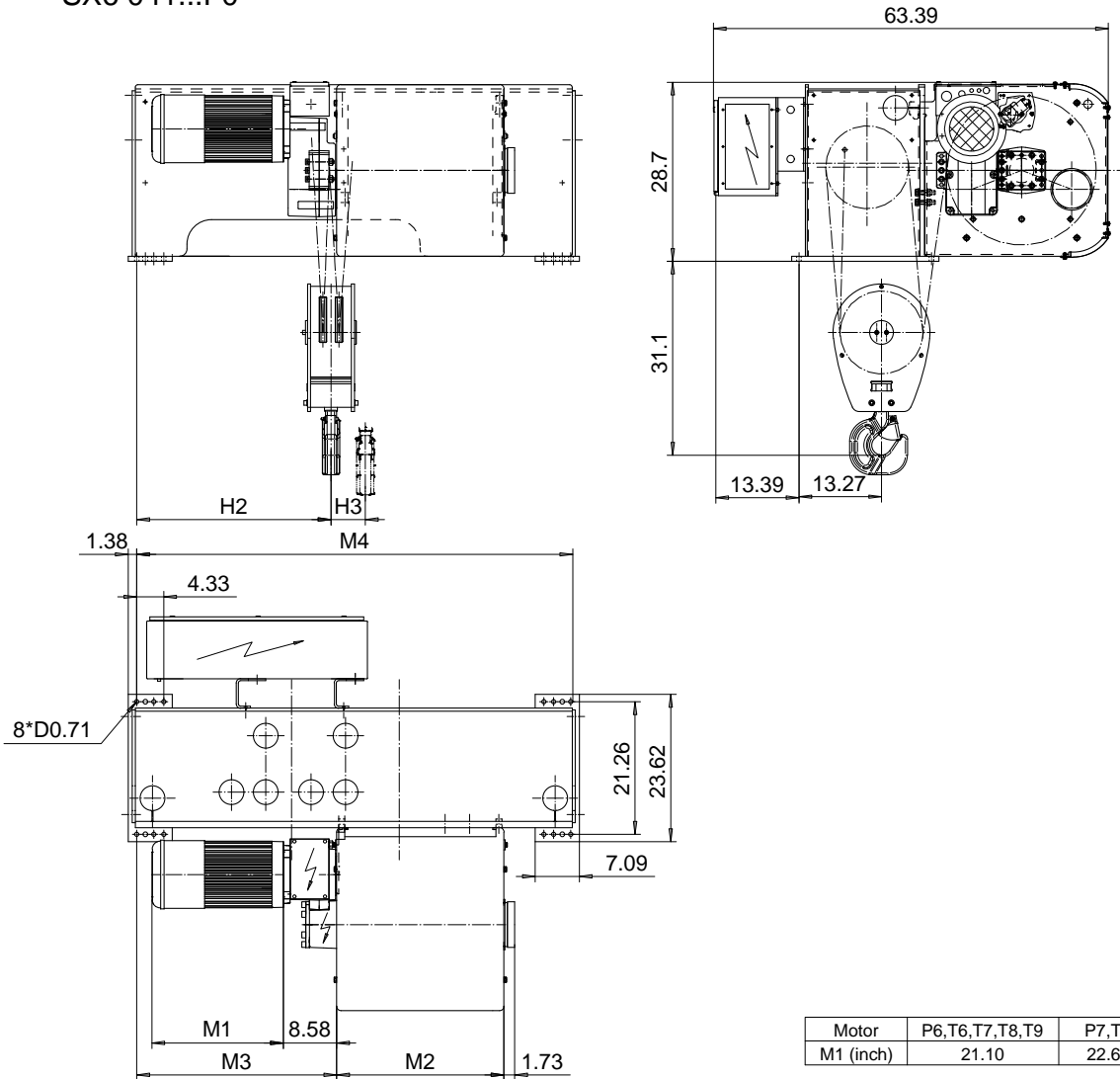

Motor	P6,T6,T7,T8,T9	P7,TA	P8
M1 (inch)	21.10	22.67	27.99

HOL (ft)	Length code	M2 (inch)	M3 (inch)	M4 (inch)	H2 (inch)	H3 (inch)	Weight (lb)
24'-6"	C	18.18	32.09	69.68	31.80	2.71	2800
34'-5"	D	22.12	32.09	69.68	31.80	3.70	2850
45'-11"	E	26.85	32.09	69.68	31.80	4.92	2950
59'-0"	F	32.75	18.70	69.68	18.53	6.33	3050
77'-1"	G	40.23	18.70	69.68	18.53	8.26	3250
100'-0"	H	50.07	18.46	101.57	18.29	10.74	3800
131'-2"	J	63.85	18.46	101.57	18.29	14.17	4000
159'-1"	K	75.66	18.46	101.57	18.29	17.08	4200

Load (TON)	Class ASME	Hoisting motor			
		Hoisting speed (ft/min): Gear code			
		16/2.4 : E	20/3.1 : F	25/3.9 : G	30 : H 40 : J
12 1/2	H4+	P6,T6	P6,T6	P7,T7	T8 T9
15	H4	P6,T6	P6,T6	P7,T7	T8 T9
20	H3	P6,T6	P7,T7	P8,T8	T9 TA

ETFPAL Design 2002-09-02 Date	ETFPAL Chd Appd	Ref Drawing	QD-F-04
SLEQDOCV Owner Dept	HOIST; FIXED 4 ROPE FALLS		1 of 15 Folder
R&M R&M MATERIALS HANDLING, INC. HOIST & CRANE PRODUCTS SHELDONVILLE, OHIO	D002143-A		Issue 6

This document is the absolute property of R&M Materials Handling, Inc. This document must not be copied without the written permission of R&M Materials Handling, Inc. The contents thereof must not be disclosed to a third party nor be used for any unauthorized purpose. Contravention will be prosecuted.