

**FOOT MOUNT, 4 PART DOUBLE**  
**Hoist type:**  
**SX6 042...F0**

**US-60Hz**

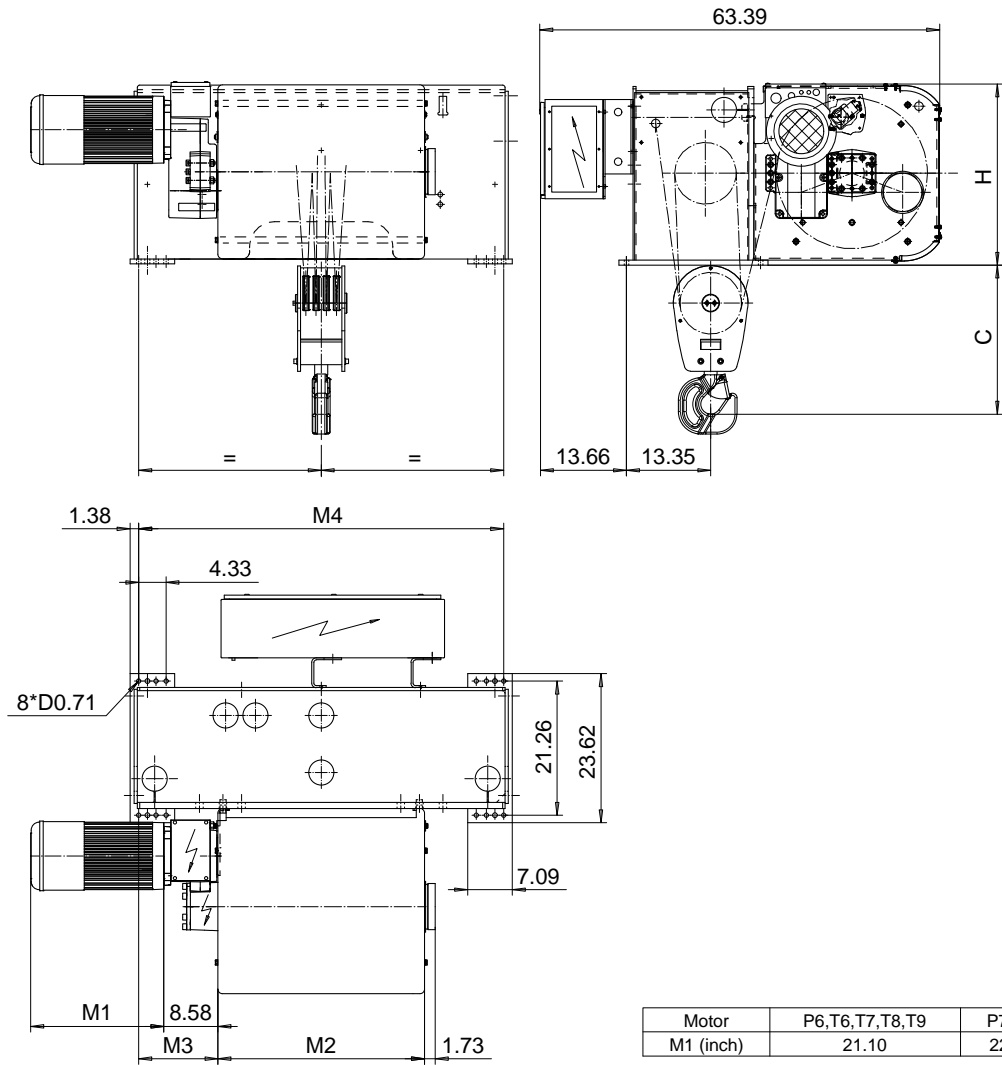

Motor	P6,T6,T7,T8,T9	P7,TA	P8
M1 (inch)	21.10	22.67	27.99

HOL (ft)	Length code	M2 (inch)	M3 (inch)	M4 (inch)	H (inch)	C (inch)	Weight (lb)
26'-3"	E	26.85	15.51	57.87	28.74	23.62	2900
36'-1"	F	32.75	12.56	57.87	28.74	23.62	3000
47'-7"	G	40.23	8.82	57.87	28.74	23.62	3100
64'-0"	H	50.07	23.58	97.24	28.74	29.52	3750
85'-4"	J	63.85	16.69	97.24	28.74	29.52	3950
103'-4"	K	75.66	10.79	97.24	28.74	29.52	4150
126'-4"	L	89.44	17.68	124.80	32.68	29.52	5050
141'-1"	M	99.29	12.76	124.80	32.68	29.52	5250
160'-9"	N	111.10	6.85	124.80	32.68	29.52	5450

Load (TON)	Class ASME	Hoisting motor				
		Hoisting speed (ft/min): Gear code				
		16/2.4 : E	20/3.1 : F	25/3.9 : G	30 : H	40 : J
12 1/2	H4+	P6,T6	P6,T6	P7,T7	T8	T9
15	H4	P6,T6	P6,T6	P7,T7	T8	T9
20	H3	P6,T6	P7,T7	P8,T8	T9	TA

ETFPAL Design 2002-09-03 Date	ETFPAL Chd Appd	Ref Drawing	QD-F-24
SLEQDOCV Owner Dept	HOIST; FIXED 2x4 ROPE FALLS		1 of 13 Folder
R&M R&M MATERIALS HANDLING, INC. HOIST & CRANE PRODUCTS SHELDONVILLE, OHIO	D002155-A		Issue 6

This document is the absolute property of R&M Materials Handling, Inc. This document must not be copied without the written permission of R&M Materials Handling, Inc. The contents thereof must not be disclosed to a third party nor be used for any unauthorized purpose. Contravention will be prosecuted.