

FOOT MOUNT, 8 PART SINGLE

Hoist type:

SX6 081...F0

US-60Hz

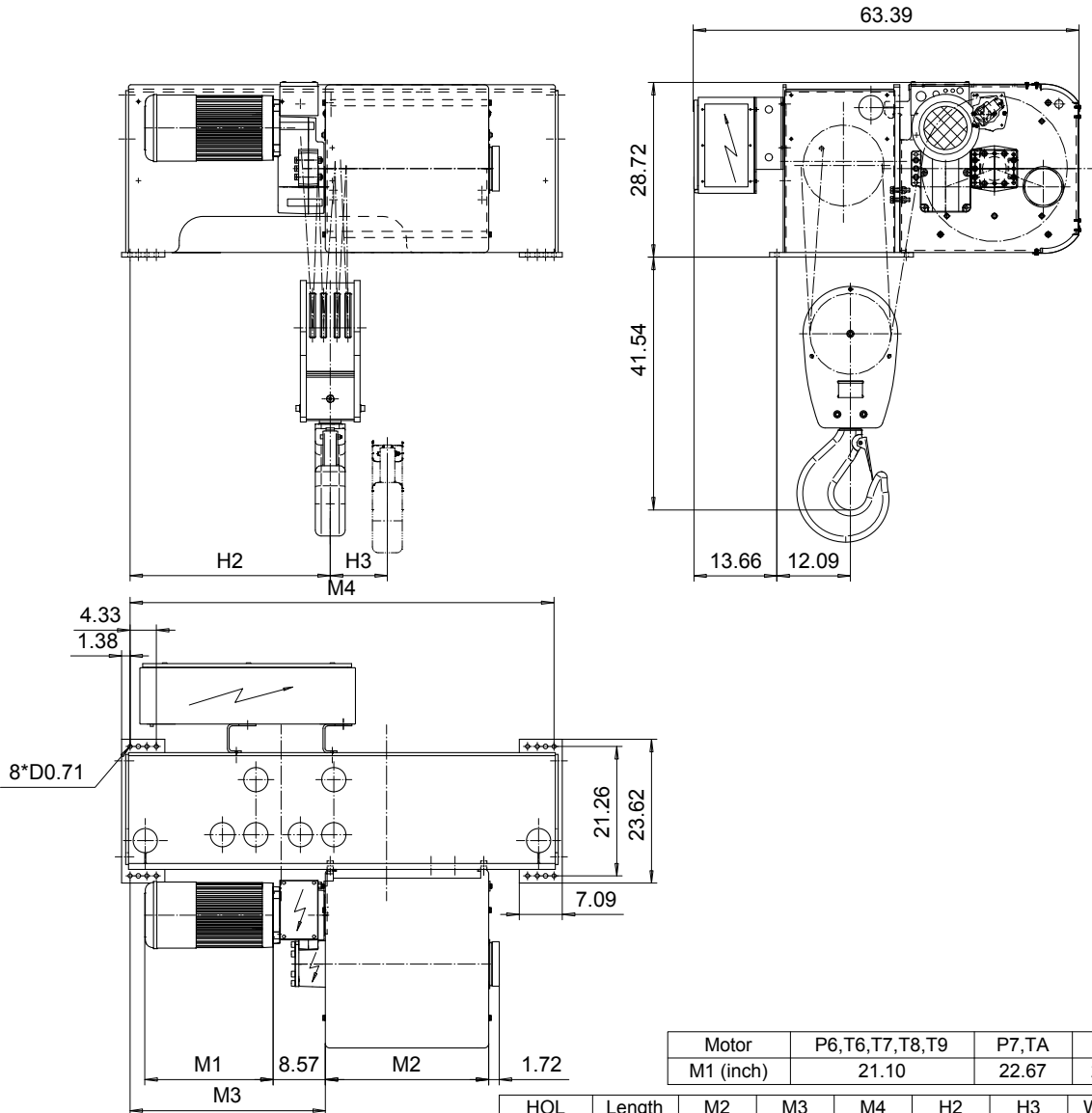

Motor	P6,T6,T7,T8,T9	P7,TA	P8
M1 (inch)	21.10	22.67	27.99

HOL (ft)	Length code	M2 (inch)	M3 (inch)	M4 (inch)	H2 (inch)	H3 (inch)	Weight (lb)
22'-11"	E	26.85	32.09	69.68	33.26	2.48	3250
29'-6"	F	32.75	18.70	69.68	19.99	3.18	3350
37'-8"	G	40.23	18.70	69.68	19.99	4.13	3550
49'-2"	H	50.07	18.46	101.57	19.75	5.39	4100
65'-7"	J	63.85	18.46	101.57	19.75	7.08	4300
78'-8"	K	75.66	18.46	101.57	19.75	8.54	4500

Load (TON)	Class ASME	Hoisting motor					
		Hoisting speed (ft/min): Gear code					
		8/1.2: E	10/1.5: F	12.5/1.9: G	12.5: G	16: H	20: J
30	H4	P6,T6	P7,T7	---	T8	T9	TA
40	H3	P6,T6	P7,T7	P8	T8	T9	TA

ETFPAL	ETFPAL	Appd	Ref Drawing	QD-F-08
Design	2002-09-02	Date	HOIST; FIXED	
SLEQDOCV	Owner Dept	8 ROPE FALLS		1 of 15
R&M	S&M MATERIALS HANDLING, INC.	HOIST & CRANE PRODUCTS		Folder
		D002148-A		Issue
				7

This document is the absolute property of R&M Materials Handling, Inc. This document must not be copied without the written permission of R&M Materials Handling, Inc. The contents thereof must not be disclosed to a third party nor be used for any unauthorized purpose. Contravention will be prosecuted.