

# FOOT MOUNT, 8 PART DOUBLE

Hoist type:

SX6 082...F0

US-60Hz

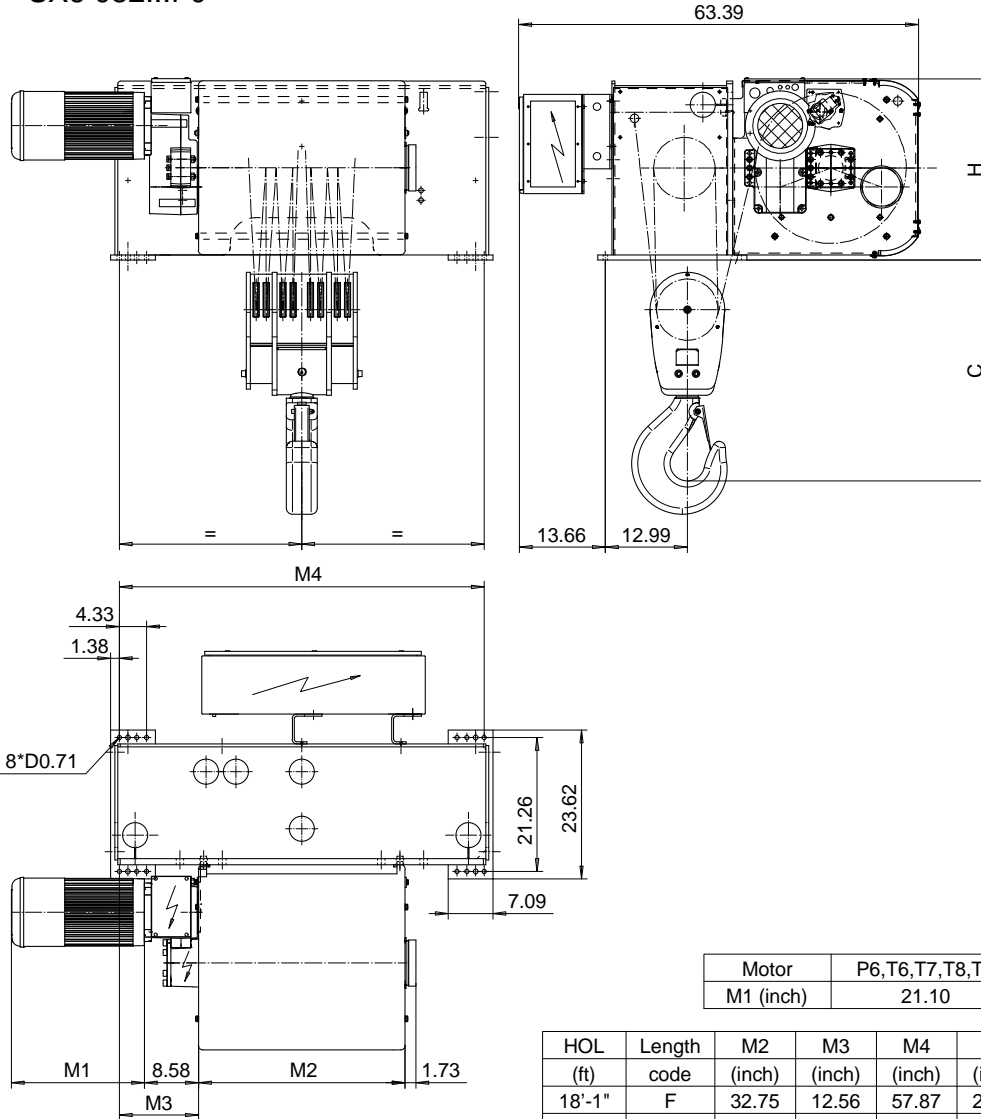

Motor	P6,T6,T7,T8,T9	P7,TA	P8
M1 (inch)	21.10	22.67	27.99

HOL (ft)	Length code	M2 (inch)	M3 (inch)	M4 (inch)	H (inch)	C (inch)	Weight (lb)
18'-1"	F	32.75	12.56	57.87	28.74	35.03	3300
23'-0"	G	40.23	8.82	57.87	28.74	35.03	3400
31'-2"	H	50.07	23.58	97.24	28.74	41.33	4050
42'-8"	J	63.85	16.69	97.24	28.74	41.33	4250
50'-10"	K	75.66	10.79	97.24	28.74	41.33	4450
62'-4"	L	89.44	17.68	124.80	32.68	41.33	5350
70'-6"	M	99.29	12.76	124.80	32.68	41.33	5550
80'-5"	N	111.10	6.85	124.80	32.68	41.33	5770

Load (TON)	Class ASME	Hoisting motor					
		Hoisting speed (ft/min): Gear code					
		8/1.2: E	10/1.5: F	12.5/1.9: G	12.5: G	16: H	20: J
30	H4	P6,T6	P7,T7	----	T8	T9	TA
40	H3	P6,T6	P7,T7	P8	T8	T9	TA

ETTPAL Design	KHHMKH Chd	Appd	Ref Drawing	QD-F-28
2002-09-03 Date	HOIST; FIXED			
SLEQDOCV Owner Dept	2x8 ROPE FALLS			
R&M R&M MATERIALS HANDLING, INC. BUCKLE & CHAIN PRODUCTS SPRINGFIELD, OHIO	D002159-A			Issue 7

This document is the absolute property of R&M Materials Handling, Inc. This document must not be copied without the written permission of R&M Materials Handling, Inc. The contents thereof must not be disclosed to a third party nor be used for any unauthorized purpose. Contravention will be prosecuted.