

US-60Hz

NORMAL HEADROOM, 4 PART SINGLE Hoist type:
SX6 041...N0

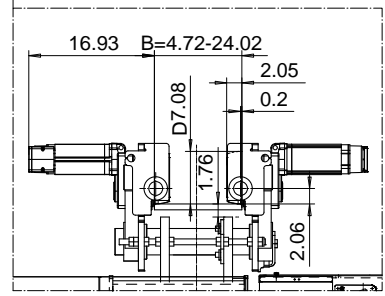

OPTION: CURVED TRACK SUSPENSION

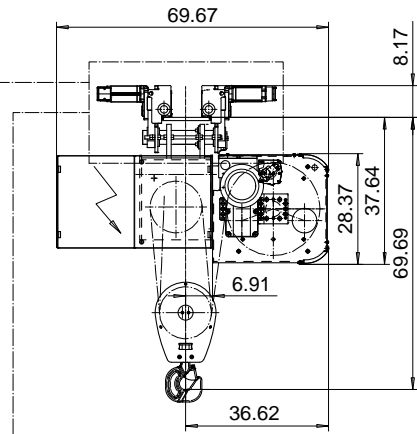
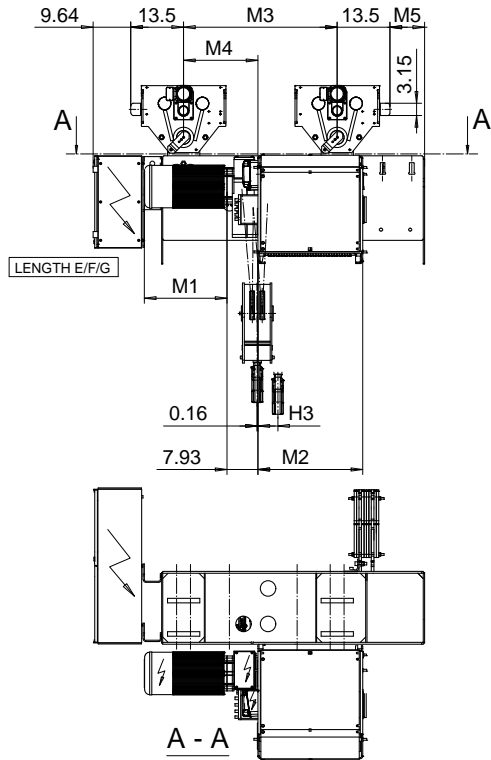
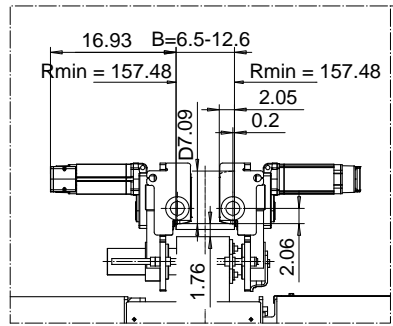

Motor	P6,T6,T7,T8,T9	P7,TA	P8
M1 (inch)	21.10	22.67	27.99

HOL (ft)	Length code	M2 (inch)	M3 (inch)	M4 (inch)	M5 (inch)	H3 (inch)	Weight (lb)
24'- 6"	C	18.19	47.24	19.06	- 7.87	2.71	4190
34'- 5"	D	22.13	47.24	19.06	- 7.87	3.70	4250
45'-11"	E	26.85	39.37	19.06	8.86	4.92	4475
59'-0"	F	32.76	39.37	19.06	8.86	6.33	4700
77'- 1"	G	40.24	39.37	19.06	8.86	8.26	5025
100'-0"	H	50.08	57.09	22.60	30.12	10.74	5700
131'-2"	J	63.86	57.09	22.60	30.12	14.17	6350
159'- 1"	K	75.67	57.09	22.60	30.12	17.08	6800

Note: Weight when B = 12"

Load (TON)	Class ASME	Hoisting motor					
		Hoisting speed (ft/min): Gear code					
		16/2.4 E	20/3.1: F	25/3.9: G	30: H	40: J	
12 1/2	H4+	P6,T6	P6,T6	P7,T7	T8	T9	
15	H4	P6,T6	P6,T6	P7,T7	T8	T9	
20	H3	P6,T6	P7,T7	P8,T8	T9	TA	

This document is the absolute property of R&M Materials Handling, Inc. This document must not be copied without the written permission of R&M Materials Handling, Inc. The contents thereof must not be disclosed to a third party nor be used for any unauthorized purpose. Contravention will be prosecuted.

ETTVPH Design	ETTPAL Appd	Ref Drawing	QD-N-04
2003-09-04 Date	TROLLEY; NORMAL HEADROOM		
SLEQDOCV Owner Dept	4 ROPE FALLS		
R&M MATERIALS HANDLING, INC. SECT 4 GEAR PRODUCTS SUNBELT, IND	D002694-A		
			2