

NORMAL HEADROOM, 8 PART DOUBLE
Hoist type:
SX6 082...N0

US-60Hz

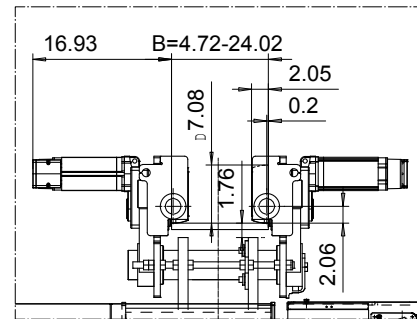

OPTION: CURVED TRACK SUSPENSION

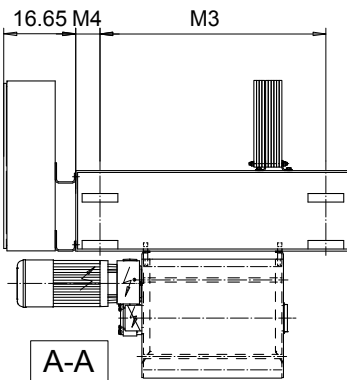
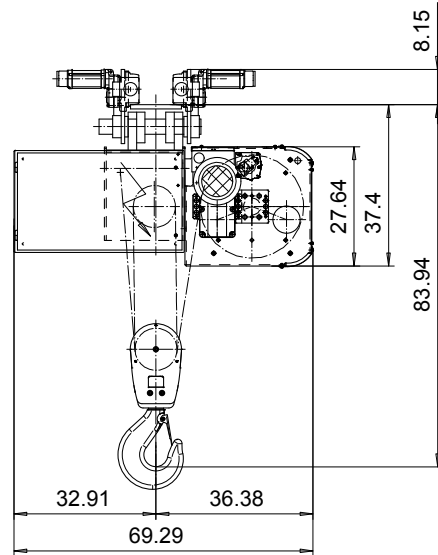
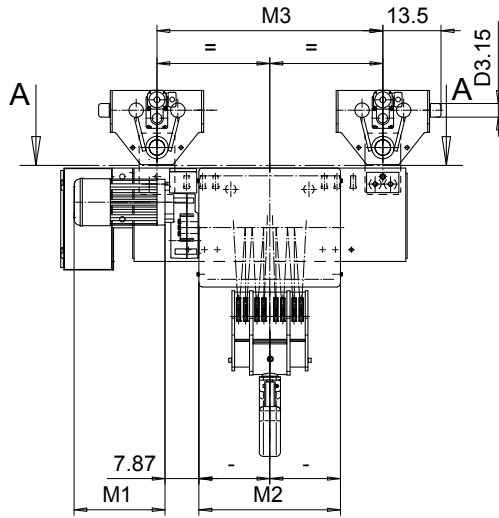
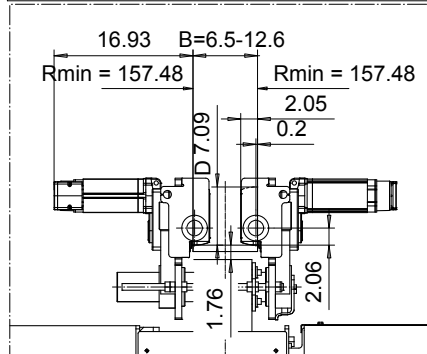

Motor	P6,T6,T7,T8,T9	P7,TA	P8
M1 (inch)	21.10	22.67	27.99

HOL (ft)	Length code	M2 (inch)	M3 (inch)	M4 (inch)	Weight (lb)
18'-1"	F	32.75	52.36	5.71	4100
23'-0"	G	40.23	52.36	5.71	4300
31'-2"	H	50.07	75.98	5.71	4700
42'-8"	J	63.85	75.98	5.71	5200
50'-10"	K	75.66	52.36	20.87	5600
62'-4"	L	89.44	52.36	20.87	6300
70'-6"	M	99.29	52.36	31.69	6700
80'-5"	N	111.10	52.36	31.69	7200

Note: Weight when B = 12"

Load (TON)	Class ASME	Hoisting motor				
		Hoisting speed (ft/min): Gear code				
		8/1.2: E	10/1.5: F	12.5/1.9: G	16: H	20: J
30	H4	P6,T6	P6,T6	P7,T7	T8	T9
40	H3	P6,T6	P7,T7	P8,T8	T9	TA

This document is the absolute property of R&M Materials Handling, Inc. This document must not be copied without the written permission of R&M Materials Handling, Inc. The contents thereof must not be disclosed to a third party nor be used for any unauthorized purpose. Contravention will be prosecuted.

CSDTLI Design	KHHMKKH Chd	Appd	Ref Drawing	QD-N-28
2003-04-16 Date	TROLLEY; NORMAL HEADROOM			
SLEQDCV Owner Dept	2X8 ROPE FALLS			
R&M MATERIALS HANDLING, INC. HOIST & CRANE PRODUCTS	D002538-A			
	3			