

Sales Policy

QX / QL Crane Components

March 2, 2009

SALES POLICY

Terms and Conditions of Sale

All sales are subject to the R&M Materials Handling, Inc Standard Terms and Conditions of Sale (Revision 101707), a copy of which is available at www.rmhoist.com or upon request from your R&M Materials Handling, Inc. customer service/sales representatives and the terms of which are incorporated as if fully rewritten herein.

Currency: CAD

R&M Materials Handling, Inc.
4501 Gateway Blvd.
Springfield, OH 45502



www.rmhoist.com

List prices FOB factory, Springfield, Ohio,
subject to change without notice.

Phone: 937-328-5100 Fax: 937-325-5319

This page intentionally left blank.

Currency: CAD
Units: METRIC
Frequency: 60 Hz

QX / QL Crane Components

March 2, 2009

QX Crane Components for Spacemaster® SX electric wire rope hoists

QL Crane Components for LoadMate® electric chain hoists

Table of Contents	
Description	Page No.
Under Running End Truck Pricing	1
Top Running End Truck Pricing	6
End Truck Joint Plate Pricing	11
End Truck Bumper Pricing	13
Bridge Drive Pricing	14
QX Bridge Panel Pricing	17
QL Bridge Panel Pricing	21
Bridge Inverter Pricing	22
Pushbutton Pendant Pricing	23
RaCon Series II Radio Control System Pricing	24
RaCon Radio Control System Pricing	25
Crane Component Options Pricing	26
Spare Parts Packages Pricing	29

Note: Festoon package selection and pricing is available through R&M's **QuoteMaster®** program.

R&M Materials Handling, Inc.
4501 Gateway Blvd.
Springfield, OH 45502



www.rmhoist.com

List prices FOB factory, Springfield, Ohio,
subject to change without notice.

Phone: 937-328-5100 Fax: 937-325-5319

Currency: CAD
 Units: METRIC
 Frequency: 60 Hz

QX/QL Crane Components
 UNDER RUNNING END TRUCK PRICING

Page 1
 March 2, 2009

Type	Runway Beam Flange Width Range (mm)	Whl. Dia. (mm)	Wheel Base (mm)	Approx. weight/trk. (kg)	Max. Static Corner Load (kN)	List Price per End Truck	Lead Time (weeks)
RU08-12	73 - 120	80	1200	110	25	1999	8-10
	121 - 168						
	169 - 216						
	217 - 264						
	265 - 313						
RU08-14	73 - 120	80	1400	117	25	2058	8-10
	121 - 168						
	169 - 216						
	217 - 264						
	265 - 313						
RU08-18	73 - 120	80	1800	131	25	2117	2-4
	121 - 168						
	169 - 216						
	217 - 264						
	265 - 313						
RU08-23	73 - 120	80	2300	148	23	2234	2-4
	121 - 168						
	169 - 216						
	217 - 264						
	265 - 313						

Note: Maximum Static Corner Load is based on Fem 2m duty at 32 m/min.

RU/RH/UT style end truck is a 8-wheel end truck - see outline drawing.

Specify the flange width of the runway beam when ordering under running end trucks

Drives, joint plates, and bumpers are sold separately.

End Truck	Suitable Bridge Drive
UT16	DS3, DS4
RU08, RU10, RH10	GEK



R&M Materials Handling, Inc.
 4501 Gateway Blvd.
 Springfield, OH 45502

www.rmhoist.com

List prices FOB factory, Springfield, Ohio,
 subject to change without notice.

Phone: 937-328-5100 Fax: 937-325-5319

Currency: CAD
 Units: METRIC
 Frequency: 60 Hz

QX/QL Crane Components
 UNDER RUNNING END TRUCK PRICING

Page 2
 March 2, 2009

Type	Runway Beam Flange Width Range (mm)	Whl. Dia. (mm)	Wheel Base (mm)	Approx. weight/trk. (kg)	Max. Static Corner Load (kN)	List Price per End Truck	Lead Time (weeks)
RU08-28	73 - 120	80	2800	165	20	2352	8-10
	121 - 168						
	169 - 216						
	217 - 264						
	265 - 313						
RU10-12	82 - 130	100	1200	161	46	2594	8-10
	131 - 178						
	179 - 226						
	227 - 274						
	275 - 322						
RU10-14	82 - 130	100	1400	171	46	2661	8-10
	131 - 178						
	179 - 226						
	227 - 274						
	275 - 322						
RU10-18	82 - 130	100	1800	191	46	2715	2-4
	131 - 178						
	179 - 226						
	227 - 274						
	275 - 322						

Note: Maximum Static Corner Load is based on Fem 2m duty at 32 m/min.

RU/RH/UT style end truck is a 8-wheel end truck - see outline drawing.

Specify the flange width of the runway beam when ordering under running end trucks

Drives, joint plates, and bumpers are sold separately.

End Truck	Suitable Bridge Drive
UT16	DS3, DS4
RU08, RU10, RH10	GEK



R&M Materials Handling, Inc.
 4501 Gateway Blvd.
 Springfield, OH 45502

www.rmhoist.com

List prices FOB factory, Springfield, Ohio,
 subject to change without notice.
 Phone: 937-328-5100 Fax: 937-325-5319

Currency: CAD
 Units: METRIC
 Frequency: 60 Hz

QX/QL Crane Components

UNDER RUNNING END TRUCK PRICING

Page 3
 March 2, 2009

Type	Runway Beam Flange Width Range (mm)	Whl. Dia. (mm)	Wheel Base (mm)	Approx. weight/trk. (kg)	Max. Static Corner Load (kN)	List Price per End Truck	Lead Time (weeks)
RU10-23	82 - 130	100	2300	217	46	2769	2-4
	131 - 178						
	179 - 226						
	227 - 274						
	275 - 322						
RU10-28	82 - 130	100	2800	275	46	2838	2-4
	131 - 178						
	179 - 226						
	227 - 274						
	275 - 322						
RU10-32	82 - 130	100	3200	299	44	2898	8-10
	131 - 178						
	179 - 226						
	227 - 274						
	275 - 322						
RU10-35	82 - 130	100	3500	318	40	2951	8-10
	131 - 178						
	179 - 226						
	227 - 274						
	275 - 322						

Note: Maximum Static Corner Load is based on Fem 2m duty at 32 m/min.

RU/RH/UT style end truck is a 8-wheel end truck - see outline drawing.

Specify the flange width of the runway beam when ordering under running end trucks

Drives, joint plates, and bumpers are sold separately.

End Truck	Suitable Bridge Drive
UT16	DS3, DS4
RU08, RU10, RH10	GEK

R&M Materials Handling, Inc.
 4501 Gateway Blvd.
 Springfield, OH 45502



www.rmhoist.com

List prices FOB factory, Springfield, Ohio,
 subject to change without notice.

Phone: 937-328-5100 Fax: 937-325-5319

Currency: CAD
 Units: METRIC
 Frequency: 60 Hz

QX/QL Crane Components
 UNDER RUNNING END TRUCK PRICING

Page 4
 March 2, 2009

Type	Runway Beam Flange Width Range (mm)	Whl. Dia. (mm)	Wheel Base (mm)	Approx. weight/trk. (kg)	Max. Static Corner Load (kN)	List Price per End Truck	Lead Time (weeks)
RH10-14	82 - 130	100	1400	285	46	3772	8-10
	131 - 178						
	179 - 226						
	227 - 274						
	275 - 322						
RH10-18	82 - 130	100	1800	305	46	3821	8-10
	131 - 178						
	179 - 226						
	227 - 274						
	275 - 322						
RH10-23	82 - 130	100	2300	330	46	3882	8-10
	131 - 178						
	179 - 226						
	227 - 274						
	275 - 322						
RH10-28	82 - 130	100	2800	370	46	3942	8-10
	131 - 178						
	179 - 226						
	227 - 274						
	275 - 322						

Note: Maximum Static Corner Load is based on Fem 2m duty at 32 m/min.

RU/RH/UT style end truck is a 8-wheel end truck - see outline drawing.

Specify the flange width of the runway beam when ordering under running end trucks

Drives, joint plates, and bumpers are sold separately.

End Truck	Suitable Bridge Drive
UT16	DS3, DS4
RU08, RU10, RH10	GEK



R&M Materials Handling, Inc.
 4501 Gateway Blvd.
 Springfield, OH 45502

www.rmhoist.com

List prices FOB factory, Springfield, Ohio,
 subject to change without notice.

Phone: 937-328-5100 Fax: 937-325-5319

Currency: CAD
 Units: METRIC
 Frequency: 60 Hz

QX/QL Crane Components
 UNDER RUNNING END TRUCK PRICING

Page 5
 March 2, 2009

Type	Runway Beam Flange Width Range (mm)	Whl. Dia. (mm)	Wheel Base (mm)	Approx. weight/trk. (kg)	Max. Static Corner Load (kN)	List Price per End Truck	Lead Time (weeks)
UT16-12	99 - 200	160	1200	370	70	5379	8-10
UT16-12	200 - 331	160	1200	380	70	5379	8-10
UT16-14	99 - 200	160	1400	405	70	5459	8-10
UT16-14	200 - 331	160	1400	415	70	5459	8-10
UT16-18	99 - 200	160	1800	440	70	5652	8-10
UT16-18	200 - 331	160	1800	450	70	5652	8-10
UT16-22	99 - 200	160	2200	480	70	5800	2-4
UT16-22	200 - 331	160	2200	490	70	5800	2-4
UT16-28	99 - 200	160	2800	540	70	6096	8-10
UT16-28	200 - 331	160	2800	550	70	6096	8-10

Note: Maximum Static Corner Load is based on Fem 2m duty at 32 m/min.
 RU/RH/UT style end truck is a 8-wheel end truck - see outline drawing.
 Specify the flange width of the runway beam when ordering under running end trucks
 Drives, joint plates, and bumpers are sold separately.

End Truck	Suitable Bridge Drive
UT16	DS3, DS4
RU08, RU10, RH10	GEK

R&M Materials Handling, Inc.
 4501 Gateway Blvd.
 Springfield, OH 45502



www.rmhoist.com

List prices FOB factory, Springfield, Ohio,
 subject to change without notice.
 Phone: 937-328-5100 Fax: 937-325-5319

Currency: CAD
 Units: METRIC
 Frequency: 60 Hz

QX/QL Crane Components
 TOP RUNNING END TRUCK PRICING

Page 6
 March 2, 2009

Type	Wheel Tread Width Range (mm)	Whl. Dia. (mm)	Wheel Base (mm)	Approx. weight/trk. (kg)	List Price per End Truck	Lead Time (weeks)	
						S.G.	D.G.
RTL09-13	50 - 70	90	1250	53	818	8-10	NA
RTL09-16	50 - 70	90	1600	67	909	8-10	8-10
RTL09-20	50 - 70	90	2000	75	1029	8-10	8-10
RTN09-13	50 - 70	90	1250	78	1176	8-10	NA
RTN09-16	50 - 70	90	1600	100	1282	2-4	2-4
RTN09-20	50 - 70	90	2000	114	1390	2-4	2-4
RTN09-25	50 - 70	90	2500	133	1497	2-4	2-4
RTN11-16	52 - 87	110	1600	127	1498	2-4	2-4
RTN11-20	52 - 87	110	2000	146	1582	2-4	2-4
RTN11-25	52 - 87	110	2500	169	1680	2-4	2-4
RTN11-32	52 - 87	110	3200	199	1817	2-4	2-4

See outline drawing for wheel load information or use R&M's **QuoteMaster**® program.
 Drives, joint plates, and bumpers are sold separately.
 Bogie end truck weight and price is for two end trucks plus connector.

End Truck	Suitable Bridge Drive
RSN09, RSN11, RTL09, RTN09, RTN11, RT14	GES3
RT20	GES3, GES4
RT25, RT32	GES4, GES5
RT50	GES5



R&M Materials Handling, Inc.
 4501 Gateway Blvd.
 Springfield, OH 45502

www.rmhoist.com

List prices FOB factory, Springfield, Ohio,
 subject to change without notice.
 Phone: 937-328-5100 Fax: 937-325-5319

Currency: CAD
 Units: METRIC
 Frequency: 60 Hz

QX/QL Crane Components

Page 7
 March 2, 2009

TOP RUNNING END TRUCK PRICING

Type	Wheel Tread Width Range (mm)	Whl. Dia. (mm)	Wheel Base (mm)	Approx. weight/trk. (kg)	List Price per End Truck	Lead Time (weeks)	
						S.G.	D.G.
RT14-14	50 - 75	140	1400	193	1421	8-10	8-10
RT14-18	50 - 75	140	1800	217	1498	8-10	8-10
RT14-22	50 - 75	140	2200	239	1592	2-4	2-4
RT14-27	50 - 75	140	2700	268	1687	2-4	8-10
RT14-31	50 - 75	140	3100	290	1800	8-10	8-10
RT14-38	50 - 75	140	3800	330	1914	8-10	8-10
RT20-18	55 - 100	200	1800	231	2426	8-10	8-10
RT20-22	55 - 100	200	2200	260	2540	2-4	8-10
RT20-27	55 - 100	200	2700	297	2673	2-4	2-4
RT20-31	55 - 100	200	3100	326	2881	2-4	2-4
RT20-38	55 - 100	200	3800	377	3023	8-10	8-10
RT20B-12	55 - 100	200	1200	416	5137	NA	2-4
RT20B-14	55 - 100	200	1400	444	5383	NA	8-10
RT20B-16	55 - 100	200	1600	474	5526	NA	8-10
RT20B-18	55 - 100	200	1800	502	5818	NA	8-10
RT20B-20	55 - 100	200	2000	560	6055	NA	8-10

See outline drawing for wheel load information or use R&M's **QuoteMaster**[®] program.

Drives, joint plates, and bumpers are sold separately.

Bogie end truck weight and price is for two end trucks plus connector.

End Truck	Suitable Bridge Drive
RSN09, RSN11, RTL09, RTN09, RTN11, RT14	GES3
RT20	GES3, GES4
RT25, RT32	GES4, GES5
RT50	GES5



R&M Materials Handling, Inc.
 4501 Gateway Blvd.
 Springfield, OH 45502

www.rmhoist.com

List prices FOB factory, Springfield, Ohio,
 subject to change without notice.

Phone: 937-328-5100 Fax: 937-325-5319

Currency: CAD
 Units: METRIC
 Frequency: 60 Hz

QX/QL Crane Components

Page 8
 March 2, 2009

TOP RUNNING END TRUCK PRICING

Type	Wheel Tread Width Range (mm)	Whl. Dia. (mm)	Wheel Base (mm)	Approx. weight/trk. (kg)	List Price per End Truck	Lead Time (weeks)	
						S.G.	D.G.
RT25-22	55 - 100	250	2200	376	3601	8-10	8-10
RT25-27	55 - 100	250	2700	426	3942	2-4	8-10
RT25-31	55 - 100	250	3100	493	4284	8-10	2-4
RT25-38	55 - 100	250	3800	641	4568	8-10	8-10
RT25-45	55 - 100	250	4500	681	4910	8-10	8-10
RT25-50	55 - 100	250	5000	739	5363	8-10	8-10
RT25-55	55 - 100	250	5500	796	5895	8-10	8-10
RT25B-14	55 - 100	250	1400	637	8966	NA	8-10
RT25B-16	55 - 100	250	1600	677	9411	NA	8-10
RT25B-18	55 - 100	250	1800	717	9828	NA	8-10
RT25B-20	55 - 100	250	2000	759	10273	NA	8-10
RT32-22	55 - 100	320	2200	488	5572	8-10	8-10
RT32-27	55 - 100	320	2700	544	5838	8-10	8-10
RT32-31	55 - 100	320	3100	596	6047	8-10	2-4
RT32-38	55 - 100	320	3800	733	6464	8-10	8-10
RT32-45	55 - 100	320	4500	765	6653	8-10	8-10
RT32-50	55 - 100	320	5000	920	7487	8-10	8-10
RT32-55	55 - 100	320	5500	986	8074	8-10	8-10

See outline drawing for wheel load information or use R&M's **QuoteMaster**® program.

Drives, joint plates, and bumpers are sold separately.

Bogie end truck weight and price is for two end trucks plus connector.

End Truck	Suitable Bridge Drive
RSN09, RSN11, RTL09, RTN09, RTN11, RT14	GES3
RT20	GES3, GES4
RT25, RT32	GES4, GES5
RT50	GES5



R&M Materials Handling, Inc.
 4501 Gateway Blvd.
 Springfield, OH 45502

www.rmhoist.com

List prices FOB factory, Springfield, Ohio,
 subject to change without notice.

Phone: 937-328-5100 Fax: 937-325-5319

Currency: CAD
 Units: METRIC
 Frequency: 60 Hz

QX/QL Crane Components

Page 9
 March 2, 2009

TOP RUNNING END TRUCK PRICING

Type	Wheel Tread Width Range (mm)	Whl. Dia. (mm)	Wheel Base (mm)	Approx. weight/trk. (kg)	List Price per End Truck	Lead Time (weeks)	
						S.G.	D.G.
RT32B-14	55 - 100	320	1400	829	12699	NA	8-10
RT32B-16	55 - 100	320	1600	883	13315	NA	8-10
RT32B-18	55 - 100	320	1800	935	13912	NA	8-10
RT32B-20	55 - 100	320	2000	989	14576	NA	8-10
RT50-22	55 - 100	500	2200	790	8472	8-10	8-10
RT50-27	55 - 100	500	2700	900	9117	8-10	8-10
RT50-31	55 - 100	500	3100	960	9534	8-10	8-10
RT50-38	55 - 100	500	3800	1140	10197	8-10	8-10
RT50-45	55 - 100	500	4500	1320	10842	8-10	8-10
RT50-50	55 - 100	500	5000	1490	11543	8-10	8-10
RT50-55	55 - 100	500	5500	1590	11979	8-10	8-10
RT50B-16	55 - 100	500	1600	898	16945	NA	8-10
RT50B-18	55 - 100	500	1800	978	17665	NA	8-10
RT50B-20	55 - 100	500	2000	1058	18461	NA	8-10

See outline drawing for wheel load information or use R&M's **QuoteMaster**® program.

Drives, joint plates, and bumpers are sold separately.

Bogie end truck weight and price is for two end trucks plus connector.

End Truck	Suitable Bridge Drive
RSN09, RSN11, RTL09, RTN09, RTN11, RT14	GES3
RT20	GES3, GES4
RT25, RT32	GES4, GES5
RT50	GES5



R&M Materials Handling, Inc.
 4501 Gateway Blvd.
 Springfield, OH 45502

www.rmhoist.com

List prices FOB factory, Springfield, Ohio,
 subject to change without notice.

Phone: 937-328-5100 Fax: 937-325-5319

Currency: CAD
 Units: METRIC
 Frequency: 60 Hz

QX/QL Crane Components

Page 10
 March 2, 2009

TOP RUNNING END TRUCK PRICING

Type	Wheel Tread Width Range (mm)	Whl. Dia. (mm)	Wheel Base (mm)	Approx. weight/trk. (kg)	List Price per End Truck	Lead Time (weeks)	
						S.G.	D.G.
RSN09-13	50 - 70	90	1250	86	1282	8-10	N.A.
RSN09-16	50 - 70	90	1600	116	1390	8-10	8-10
RSN09-20	50 - 70	90	2000	130	1497	8-10	8-10
RSN09-25	50 - 70	90	2500	149	1658	8-10	8-10
RSN11-16	52 - 87	110	1600	179	1498	8-10	8-10
RSN11-20	52 - 87	110	2000	202	1595	8-10	8-10
RSN11-25	52 - 87	110	2500	230	1712	8-10	8-10
RSN11-32	52 - 87	110	3200	267	1924	8-10	8-10

On the RSN end truck, the girder is joined to joint plate through a shear type connection.

Samples of a shear joint connection

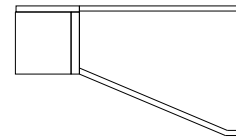
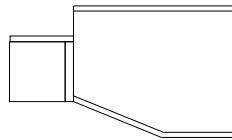
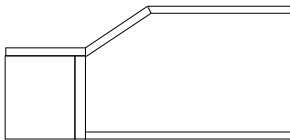

See outline drawing for wheel load information or use R&M's **QuoteMaster**® program.

Drives, end truck joint plates, and bumpers must be added separately.

End Truck	Suitable Bridge Drive
RSN09, RSN11, RTL09, RTN09, RTN11, RT14	GES3
RT20	GES3, GES4
RT25, RT32	GES4, GES5
RT50	GES5

R&M Materials Handling, Inc.
 4501 Gateway Blvd.
 Springfield, OH 45502



www.rmhoist.com

List prices FOB factory, Springfield, Ohio,
 subject to change without notice.

Phone: 937-328-5100 Fax: 937-325-5319

Currency: CAD
 Units: METRIC
 Frequency: 60 Hz

QX / QL Crane Components

Page 11
 March 2, 2009

END TRUCK JOINT PLATE PRICING

Type	Possible Girder Connection Position		Suitable for End Truck Type	Maximum Flange Width (mm)	List Price per End Truck		Lead Time (weeks)
	Profile	Box			S.G.	D.G.	
EBN09-400x200	S;M;L	S;M;L	RSN09	400	214	417	8-10
EBN11-400x255	S;M;L	S;M;L	RSN11	400	267	546	8-10
A3	S;M	S;M	RTN09, RTL09	310	139	279	2-4
A4	S;M	S;M	RTN11	360	139	279	2-4
A6	S;M	S;M	RTN11	550	139	279	8-10
K4	S;M	S;M	RT25; RT32	410	522	1042	8-10
K5	S;M	S;M	RT25; RT32; RT50	520	522	1042	2-4
K7	S;M	S;M	RT32; RT50	740	522	1042	8-10
K9	S;M	S;M	RT50	990	618	1211	8-10
L3	S;M	S;M	RT20	300	322	645	2-4
L4	S;M	S;M	RT20	410	322	645	2-4
L5	S;M	S;M	RT20	520	322	645	2-4
R3	S;M;L	S;M;L	RT20	300	398	796	8-10
R4	S;M;L	S;M;L	RT20	410	398	796	2-4
R5	S;M;L	S;M;L	RT20	520	398	796	8-10

S = Standard connection
 M = Medium connection
 L = Low connection
 H = High connection
 S.G. = Single girder
 D.G. = Double girder

Above prices apply only when ordered with end truck.
 See End Truck Technical Guide for more information.
 XXX = User specified dimension (mm)

R&M Materials Handling, Inc.
 4501 Gateway Blvd.
 Springfield, OH 45502



www.rmhoist.com

List prices FOB factory, Springfield, Ohio,
 subject to change without notice.
 Phone: 937-328-5100 Fax: 937-325-5319

Currency: CAD
Units: METRIC
Frequency: 60 Hz

QX / QL Crane Components

Page 12
March 2, 2009

END TRUCK JOINT PLATE PRICING

Type	Possible Connection Position		Suitable for End Truck Type	Maximum Flange Width (mm)	List Price per End Truck		Lead Time (weeks)
	Profile	Box			S.G.	D.G.	
S4	no	L	RT25; RT32	410	531	1061	8-10
S5	no	L	RT25; RT32	520	531	1061	8-10
S6	no	L	RT32; RT50	520	664	1327	8-10
S7	no	L	RT32; RT50	740	664	1327	8-10
BA1	S	no	RU08	See Note	129	267	2-4
BA2	S	no	RU08	See Note	129	267	2-4
BA3	S	no	RU08	See Note	129	267	2-4
SA3	S;M;H	S;M;H	RU08	300	129	267	8-10
BB2	S	no	RU10	See Note	129	267	2-4
BB3	S	no	RU10	See Note	129	267	2-4
BB4	S	no	RU10	See Note	129	267	2-4
BB5	S	no	RU10	See Note	129	267	2-4
SB4	S;M	S;M	RU10	410	129	267	8-10
HB4(A)	S;M	S;M	RH10	410	152	303	8-10
HB4(B)	S;M	S;M	RH10	410	152	303	8-10
KB2	S	no	RH10	See Note	131	273	8-10
KB3	S	no	RH10	See Note	131	273	8-10
KB4	S	no	RH10	See Note	131	273	8-10
KB5	S	no	RH10	See Note	131	273	8-10

Note: These are bolted connections without a joint plate. The different types define the bolt layout.

S = Standard connection
M = Medium connection
L = Low connection
H = High connection
S.G. = Single girder
D.G. = Double girder

Above prices apply only when ordered with end truck.
See End Truck Technical Guide for more information.
XXX = User specified dimension (mm)

R&M Materials Handling, Inc.
4501 Gateway Blvd.
Springfield, OH 45502



List prices FOB factory, Springfield, Ohio,
subject to change without notice.

www.rmhoist.com Phone: 937-328-5100 Fax: 937-325-5319

Currency: CAD
 Units: METRIC
 Frequency: 60 Hz

QX / QL Crane Components
END TRUCK BUMPER PRICING

Page 13
 March 2, 2009

Type	Code	Bumper Length (mm)	Bumper Diameter (mm)	List Price per End Truck	Lead Time (weeks)
D1801	A	53	63	45	2-4
D2240	B	68	80	69	2-4
D2241	C	85	100	113	2-4
D2242	D	105	125	136	2-4
PUR100*100	G	100	100	227	8-10
PUR160*160	H	160	160	955	8-10
PUR200*200	I	200	200	1387	8-10
PUR125*125	M	125	125	433	8-10
PUR160*240	P	240	160	910	8-10
PUR200*300	S	300	200	2002	8-10

Note: Above prices are valid only when purchased with the end truck.



R&M Materials Handling, Inc.
 4501 Gateway Blvd.
 Springfield, OH 45502

www.rmhoist.com

List prices FOB factory, Springfield, Ohio,
 subject to change without notice.
 Phone: 937-328-5100 Fax: 937-325-5319

Currency: CAD
Units: METRIC
Frequency: 60 Hz

QX / QL Crane Components

Page 14
March 2, 2009

BRIDGE DRIVE PRICING

Type	Motor Code	Inverter Motor	Approx. weight/ drive (kg)	Motor kW	Synch motor speed (rpm)	Nominal motor current @ 460V	List Price	Lead Time (weeks)
DS3	MF06LA104		20	0.55 / 0.12	3600/900	1.3	1756	2-4
DS3	MF06LA20P	x	20	0.75	3600	2.1	1539	2-4
DS3	MF07LA104		19	0.30 / 0.07	3600/900	1.3	1831	2-4
DS3	MF07LB104		20	0.55 / 0.13	3600/900	1.6	1831	2-4
DS3	MF06LA100	x	20	0.65	4800	1.3	1539	2-4
DS3	MF06LA200	x	20	0.55	3600	1.8	1418	2-4
DS3	MF06MA100	x	20	0.45	4800	2.1	1387	2-4
DS3	MF06MA200	x	20	0.37	3600	1.2	1263	2-4
DS3	MF07LA100	x	19	0.30	3600	1.0	1554	2-4
DS3	MF07LA200	x	19	0.30	1800	1.0	1554	8-10
DS3	MF07LB100	x	20	0.55	3600	1.3	1630	2-4
DS3	MF07ZC100	x	22	0.90	3600	1.9	1940	8-10
DS4	MF06LA104		20	0.55 / 0.12	3600/900	1.3	2464	2-4
DS4	MF06LA20P	x	20	0.75	3600	2.1	2237	2-4
DS4	MF07ZC104		22	0.75 / 0.18	3600/900	1.9	2407	8-10
DS4	MF06LA100	x	20	0.65	4800	2.1	2237	2-4
DS4	MF06LA200	x	20	0.55	3600	1.8	2237	2-4
DS4	MF06LB100	x	20	1.10	4800	2.9	2577	2-4
DS4	MF06LB200	x	20	1.10	3600	2.9	2521	2-4
DS4	MF06MA100	x	20	0.45	4800	2.1	2122	2-4
DS4	MF06MA200	x	20	0.37	3600	1.2	1991	2-4
DS4	MF07LB100	x	20	0.55	3600	1.3	2009	2-4
DS4	MF07LB200	x	20	0.55	1800	1.6	2009	2-4
DS4	MF07ZC100	x	22	0.90	3600	1.9	2313	2-4



R&M Materials Handling, Inc.
4501 Gateway Blvd.
Springfield, OH 45502

www.rmhoist.com

List prices FOB factory, Springfield, Ohio,
subject to change without notice.

Phone: 937-328-5100 Fax: 937-325-5319

Currency: CAD
 Units: METRIC
 Frequency: 60 Hz

QX / QL Crane Components

Page 15
 March 2, 2009

BRIDGE DRIVE PRICING

Type	Motor Code	Inverter Motor	Approx. weight/ drive (kg)	Motor kW	Synch motor speed (rpm)	Nominal motor current @ 460V	List Price	Lead Time (weeks)
GEK1	MF06LA104			0.55 / 0.12	3600/900	1.3	1338	8-10
GEK1	MF06LA20P	x		0.75	3600	2.1	1121	8-10
GEK1	MF06MA104			0.37 / 0.07	3600 / 900	0.9	1061	8-10
GEK1	MF06LA100	x		0.65	4800	2.1	1121	8-10
GEK1	MF06LA200	x		0.55	3600	1.8	1001	8-10
GEK1	MF06MA100	x		0.45	4800	2.1	970	8-10
GEK1	MF06MA200	x		0.37	3600	1.2	846	8-10
GEK2	MF06LA104			0.55 / 0.12	3600/900	1.3	1448	2-4
GEK2	MF06LA20P	x		0.75	3600	2.1	1217	2-4
GEK2	MF06MA104			0.37 / 0.07	3600 / 900	0.9	1156	2-4
GEK2	MF06LA100	x		0.65	4800	2.1	1217	2-4
GEK2	MF06LA200	x		0.55	3600	1.8	1092	2-4
GEK2	MF06MA100	x		0.45	4800	2.1	1057	2-4
GEK2	MF06MA200	x		0.37	3600	1.2	928	2-4
GES3	MF06LA104		20	0.55 / 0.12	3600 / 900	1.3	1756	2-4
GES3	MF06LA20P	x	20	0.75	3600	2.1	1539	2-4
GES3	MF06MA104		20	0.37 / 0.07	3600 / 900	0.9	1478	2-4
GES3	MF06LA100	x	20	0.65	4800	2.1	1539	2-4
GES3	MF06LA200	x	20	0.55	3600	1.8	1418	2-4
GES3	MF06MA100	x	20	0.45	4800	2.1	1387	2-4
GES3	MF06MA200	x	20	0.37	3600	1.2	1418	2-4



R&M Materials Handling, Inc.
 4501 Gateway Blvd.
 Springfield, OH 45502

www.rmhoist.com

List prices FOB factory, Springfield, Ohio,
 subject to change without notice.
 Phone: 937-328-5100 Fax: 937-325-5319

Currency: CAD
 Units: METRIC
 Frequency: 60 Hz

QX / QL Crane Components

Page 16
 March 2, 2009

BRIDGE DRIVE PRICING

Type	Motor Code	Inverter Motor	Approx. weight/ drive (kg)	Motor kW	Synch motor speed (rpm)	Nominal motor current @ 460V	List Price	Lead Time (weeks)
GES4	MF06LA104		30	0.55 / 0.12	3600 / 900	1.3	2096	2-4
GES4	MF06LA20P	x	30	0.75	3600	2.1	1971	2-4
GES4	MF06MA104		30	0.37 / 0.07	3600 / 900	0.9	1816	2-4
GES4	MF07X-104		30	0.90 / 0.20	3600 / 900	2.7	2248	2-4
GES4	MF06LA100	x	30	0.65	4800	2.1	1880	2-4
GES4	MF06LA200	x	30	0.55	3600	1.8	1880	8-10
GES4	MF06LB100	x	30	1.1	4800	2.9	2218	8-10
GES4	MF06LB200	x	30	1.10	3600	2.9	2157	2-4
GES4	MF06MA100	x	30	0.45	4800	2.1	1756	8-10
GES4	MF06MA200	x	30	0.37	3600	1.2	1634	8-10
GES5	MF07X-104		37	0.90 / 0.20	3600/900	2.7	3112	8-10
GES5	MF10M-104		40	1.50 / 0.35	3600/900	3	3389	8-10
GES5	MF06LB100	x	37	1.10	4800	2.9	3017	8-10
GES5	MF06LB200	x	37	1.10	3600	2.9	2988	8-10
GES5	MF07XA100	x	37	1.80	4800	4.3	3234	8-10
GES5	MF07XA200	x	37	1.80	3600	3.9	3450	8-10
GES5	MF07XB100	x	37	3.00	4800	7.9	3234	8-10
GES5	MF07XB200	x	37	2.50	3600	6.5	3336	8-10



R&M Materials Handling, Inc.
 4501 Gateway Blvd.
 Springfield, OH 45502

www.rmhoist.com

List prices FOB factory, Springfield, Ohio,
 subject to change without notice.
 Phone: 937-328-5100 Fax: 937-325-5319

Currency: CAD
 Units: METRIC
 Frequency: 60 Hz

QX Crane Components

BRIDGE PANEL PRICING

Page 17
 March 2, 2009

For use with two-speed hoist control and one hoist on bridge

Type	Number of Motors for Hoisting	Max. kW of each Hoist Motor	Number of Hoists on Bridge	List Price - See Note!			Lead Time (weeks)
				208/230 volt	460 volt	575 volt	
BPPX-1	1	1.8	1	1387 ⁽¹⁾	1179	1387	2-4
BPR1-1	1	0.9	1	1543	1312	1543	2-4
BPP1-1	1	2.2	1	1543	1312	1543	2-4
BPP2-1	1	4.3	1	1543	1312	1543	2-4
BPP3-1	1	5.4	1	1543	1312	1543	2-4
BPP4-1	1	9	1	1739	1478	1739	8-10
BPP5-1	1	11	1	2034	1729	2034	2-4
BPP6-1	1	18	1	2551 ⁽¹⁾	2169	2551	2-4
BPP7-1	1	21	1	3479	2957	3479	8-10
BPP8-1	1	25	1	3902	3317	3902	8-10
BP2P6-1	2	18	1	4304	3658	4304	8-10
BP2P7-1	2	25	1	5842	4966	5842	8-10

Prices are subject to change depending on the actual crane specification. To get the most accurate bridge panel and inverter prices, use R&M's QuoteMaster[®] program.

Includes disconnect switch, mainline contactor, control voltage transformer, and autotransformer for the inverter controls as needed. (Autotransformer is needed when the power supply voltage is something other than 460-3-60.)

⁽¹⁾ Lead time is 8-10 weeks.

NOTE!

The above bridge panel prices do not include the price for the bridge inverter. The bridge inverter price must be added separately. See Bridge Inverter Pricing page.



R&M Materials Handling, Inc.
 4501 Gateway Blvd.
 Springfield, OH 45502

www.rmhoist.com

List prices FOB factory, Springfield, Ohio,
 subject to change without notice.

Phone: 937-328-5100 Fax: 937-325-5319

Currency: CAD
Units: METRIC
Frequency: 60 Hz

QX Crane Components

BRIDGE PANEL PRICING

Page 18
March 2, 2009

For use with two-speed hoist control & two equal-capacity hoists on bridge

Type	Number of Motors for Hoisting	Max. kW of each Hoist Motor	Number of Hoists on Bridge	List Price - See Note!			Lead Time (weeks)
				208/230 volt	460 volt	575 volt	
BPR1-2	1	1.1	2	2205 ⁽¹⁾	1873	2205	2-4
BPP1-2	1	2.2	2	2205 ⁽¹⁾	1873	2205	2-4
BPP2-2	1	4.3	2	2205 ⁽¹⁾	1873	2205	2-4
BPP3-2	1	5.4	2	2205 ⁽¹⁾	1873	2205	2-4
BPP4-2	1	9	2	2485	2113	2485	8-10
BPP5-2	1	11	2	2905 ⁽¹⁾	2470	2905	2-4
BPP6-2	1	18	2	3644	3098	3644	8-10
BPP7-2	1	21	2	4970	4224	4970	8-10
BPP8-2	1	25	2	5575	4739	5575	8-10
BP2P6-2	2	18	2	6149	5226	6149	8-10
BP2P7-2	2	25	2	8347	7094	8347	8-10

The above panels include tandem hoist control relays to allow separate or combined hoist operation (1, 1+2, 2)

Prices are subject to change depending on the actual crane specification. To get the most accurate bridge panel and inverter prices, use R&M's QuoteMaster[®] program.

Includes disconnect switch, mainline contactor, control voltage transformer, and autotransformer for the inverter controls as needed. (Autotransformer is needed when the power supply voltage is something other than 460-3-60.)

⁽¹⁾ Lead time is 8-10 weeks.

NOTE!

The above bridge panel prices do not include the price for the bridge inverter. The bridge inverter price must be added separately. See Bridge Inverter Pricing page.

R&M Materials Handling, Inc.
4501 Gateway Blvd.
Springfield, OH 45502



www.rmhoist.com

List prices FOB factory, Springfield, Ohio,
subject to change without notice.

Phone: 937-328-5100 Fax: 937-325-5319

Currency: CAD
 Units: METRIC
 Frequency: 60 Hz

QX Crane Components

BRIDGE PANEL PRICING

Page 19
 March 2, 2009

For use with ControlMaster Plus hoist inverter

Type	Number of Motors for Hoisting	Max. kW of each Hoist Motor	Number of Hoists on Bridge	List Price - See Note!			Lead Time (weeks)
				208/230 volt	460 volt	575 volt	
BPT1-1	1	2.2	1	3546	3014	3546	8-10
BPT2-1	1	4.3	1	3546	3014	3546	8-10
BPT3-1	1	5.4	1	3546	3014	3546	8-10
BPT4-1	1	9	1	5352	4549	5352	8-10
BPT5-1	1	11	1	6497	5496	6497	8-10
BPT6-1	1	18	1	6824	5800	6824	8-10
BPT7-1	1	21	1	7715	6558	7715	8-10
BPT8-1	1	27	1	8652	7354	8652	8-10
BPT9-1	1	34	1	9589	8151	9589	8-10
BPTA-1	1	42	1	10837	9212	10837	8-10
BP2T6-1	2	18	1	10123	8606	10123	8-10
BP2T7-1	2	21	1	11684	9932	11684	8-10
BP2T8-1	2	27	1	15008	12741	15008	8-10
BP2T9-1	2	34	1	17574	14924	17574	8-10

Prices are subject to change depending on the actual crane specification. To get the most accurate bridge panel and inverter prices, use R&M's QuoteMaster[®] program.

Includes disconnect switch, mainline contactor, control voltage transformer, and autotransformer for the inverter controls as needed. (Autotransformer is needed when the power supply voltage is something other than 460-3-60.)

NOTE!

The above bridge panel prices do not include the price for the bridge inverter. The bridge inverter price must be added separately. See Bridge Inverter Pricing page.

R&M Materials Handling, Inc.
 4501 Gateway Blvd.
 Springfield, OH 45502



www.rmhoist.com

List prices FOB factory, Springfield, Ohio,
 subject to change without notice.
 Phone: 937-328-5100 Fax: 937-325-5319

Currency: CAD
 Units: METRIC
 Frequency: 60 Hz

QX Crane Components

BRIDGE PANEL PRICING

Page 20
 March 2, 2009

For use with ControlMaster Plus hoist inverter & two equal-capacity hoists on bridge

Type	Number of Motors for Hoisting	Max. kW of each Hoist Motor	Number of Hoists on Bridge	List Price - See Note!			Lead Time (weeks)
				208/230 volt	460 volt	575 volt	
BPT1-2	1	2.2	2	5065	4305	5065	8-10
BPT2-2	1	4.3	2	5065	4305	5065	8-10
BPT3-2	1	5.4	2	6584	5597	6584	8-10
BPT4-2	1	9	2	7645	6499	7645	8-10
BPT5-2	1	11	2	9239	7853	9239	8-10
BPT6-2	1	18	2	9748	8285	9748	8-10
BPT7-2	1	21	2	11022	9369	11022	8-10
BPT8-2	1	27	2	12361	10506	12361	8-10
BPT9-2	1	34	2	13698	11504	13698	8-10
BPTA-2	1	42	2	15481	13160	15481	8-10
BP2T6-2	2	18	2	14462	12293	14462	8-10
BP2T7-2	2	21	2	16692	14189	16692	8-10
BP2T8-2	2	27	2	18666	16142	18666	8-10
BP2T9-2	2	34	2	21445	18920	21445	8-10

The above panels include tandem hoist control relays to allow separate or combined hoist operation (1, 1+2, 2)

Prices are subject to change depending on the actual crane specification. To get the most accurate bridge panel and inverter prices, use R&M's QuoteMaster[®] program.

Includes disconnect switch, mainline contactor, control voltage transformer, and autotransformer for the inverter controls as needed. (Autotransformer is needed when the power supply voltage is something other than 460-3-60.)

NOTE!

The above bridge panel prices do not include the price for the bridge inverter. The bridge inverter price must be added separately. See Bridge Inverter Pricing page.



R&M Materials Handling, Inc.
 4501 Gateway Blvd.
 Springfield, OH 45502

www.rmhoist.com

List prices FOB factory, Springfield, Ohio,
 subject to change without notice.
 Phone: 937-328-5100 Fax: 937-325-5319

Currency: CAD
 Units: METRIC
 Frequency: 60 Hz

QL Crane Components

BRIDGE PANEL PRICING

Page 21
 March 2, 2009

For use with LoadMate electric chain hoist with contactor hoist control

Type	Max. kW of each Hoist Motor	Number of Hoists on Bridge	List Price - See Note!			Lead Time (weeks)
			208/230 volt	460 volt	575 volt	
BPC1-1	1.1	1	1543	1312	1543	2-4
BPC2-1	2.1	1	1543	1312	1543	2-4
BPC3-1	4.2	1	1543	1312	1543	2-4
BPC1-2	1.1	2	2205 ⁽¹⁾	1873	2205	2-4
BPC2-2	2.1	2	2205 ⁽¹⁾	1873	2205	2-4
BPC3-2	4.2	2	2205 ⁽¹⁾	1873	2205	2-4

For use with LoadMate electric chain hoist with inverter hoist control

BPV1-1	1.1	1	NA	NA	NA	---
BPV2-1	2.2	1	POA ⁽¹⁾	1312	POA ⁽¹⁾	2-4
BPV3-1	4.2	1	NA	NA	NA	---
BPV1-2	1.1	2	NA	NA	NA	---
BPV2-2	2.2	2	POA ⁽¹⁾	1873	POA ⁽¹⁾	2-4
BPV3-2	4.2	2	NA	NA	NA	---

The above BPxx-2 panels include tandem hoist control relays to allow separate or combined hoist operation (I, I+II, II)

Prices are subject to change depending on the actual crane specification. To get the most accurate bridge panel and inverter prices, use R&M's QuoteMaster[®] program.

Includes disconnect switch, mainline contactor, control voltage transformer, and autotransformer for the inverter controls as needed. (Autotransformer is needed when the power supply voltage is something other than 460-3-60.)

⁽¹⁾ Lead time is 8-10 weeks.

NOTE!

The above bridge panel prices do not include the price for the bridge inverter. The bridge inverter price must be added separately. See Bridge Inverter Pricing page.

R&M Materials Handling, Inc.
 4501 Gateway Blvd.
 Springfield, OH 45502



www.rmhoist.com

List prices FOB factory, Springfield, Ohio,
 subject to change without notice.

Phone: 937-328-5100 Fax: 937-325-5319

Type	Maximum output current		List Price	Lead Time (weeks)
	Nominal Current (A)	Starting Current (A)		
	@ 460 Volts	@ 460 Volts		

ControlMaster Select Inverter				
CMST002F	5.1	7.7	2464	2-4
CMST003F	8	12	2843	2-4
CMST004F	10	15	3223	2-4
CMST005F	13	20	4360	8-10
CMST007F	18	27	5117	8-10
CMST011F	24	36	6635	8-10
CMST015F	32	48	7581	8-10
CMST018F	42	63	9439	8-10
CMST022F	48	72	10842	8-10

ControlMaster CMXC Inverter				
CMXC 022F	5.0	7.5	644	2-4

Above prices are valid only when purchased with the bridge panel.

Currency: CAD
 Units: METRIC
 Frequency: 60 Hz

QX / QL Crane Components

Page 23
 March 2, 2009

PUSHBUTTON PENDANT PRICING

Type	ON / OFF	Hoist	Trolley	Bridge	Selector Switch	List Price	Lead Time (weeks)
PBR style Push Button Pendant							
PBR042001_00-N...PE20	X	2	0	0	0	568	2-4
PBR082201_00-N...PE20	X	2	2	0	0	568	2-4
PBR082221_00-N...PE30	X	2	2	2	0	568	2-4
PBR122221_V2-N...PE30	X	2	2	2	V2	759	2-4
PBR122221_V3-N...PE30	X	2	2	2	V3	759	2-4
PBR122221_00-N...PE3E	X	2x2	2x2	2	0	2226	2-4
PD style Push Button Pendant							
PD06-2001NC00-...H0	X	2	0	0	0	777	2-4
PD08-2201NC00-...H0	X	2	2	0	0	777	2-4
PD08-2221NC00-...P0	X	2	2	2	0	777	2-4
PD12-2221NCV2-...P0	X	2	2	2	V2	986	2-4
PD12-2221NCV3-...P0	X	2	2	2	V3	986	2-4
PD12-2221NC00-...PE	X	2x2	2x2	2	0	2374	2-4
Standby Heater for Pendant Station						189	8-10

Prices apply only when ordered with crane components or hoist.

0 = Not included
 2 = Two-speed
 V2 = 2 position selection (1 or 2)
 V3 = 3 position selection (1, 1+2, 2)
 X = Included
 PE2 = plug on SX hoist
 PE3 = plug on the moveable festoon trolley (on bridge)

Included:

Pendant cable for specified lift up to 15 m max.
 Pushbutton pendant station
 Plug



R&M Materials Handling, Inc.
 4501 Gateway Blvd.
 Springfield, OH 45502

www.rmhoist.com

List prices FOB factory, Springfield, Ohio,
 subject to change without notice.
 Phone: 937-328-5100 Fax: 937-325-5319

Currency: CAD
 Units: METRIC
 Frequency: 60 Hz

QX / QL Crane Components

RACON II RADIO REMOTE CONTROL PRICING

Page 24
 March 2, 2009

Type	Control Method	Hoist	Trolley	Bridge	Selector Switch	List Price	Lead Time (weeks)
Single system for hoist							
RaConII RH110.....	Pushbutton	2	2	---	none	2715	2-4
Single system for crane							
RaConII RS110.....	Pushbutton	2	2	2	none	2885	2-4
RaConII RF130.....	Pushbutton	2	2	2	none	3196	2-4
RaConII RF13S.....	Pushbutton	2	2	2	V3	3347	2-4
Spare transmitter (when purchased with new system - add 25% to radio list price)						+ 0.25 x list price	

Included:

2 = Two-speed

V3 = 3 position selection (1, 1+2, 2)

Main contactor On-button

Emergency Stop

Transmitter with battery and backup battery

Receiver & connection cable with ready-to-go plugs

Battery charger

R&M Materials Handling, Inc.
 4501 Gateway Blvd.
 Springfield, OH 45502



www.rmhoist.com

List prices FOB factory, Springfield, Ohio,
 subject to change without notice.

Phone: 937-328-5100 Fax: 937-325-5319

Currency: CAD
 Units: METRIC
 Frequency: 60 Hz

QX / QL Crane Components

RACON RADIO REMOTE CONTROL PRICING

Page 25
 March 2, 2009

Type	Control Method	Hoist	Trolley	Bridge	Selector Switch	List Price	Lead Time (weeks)
------	----------------	-------	---------	--------	-----------------	------------	-------------------

Single system for a crane

RaCon508MI_0...00ST	Pushbutton	2	2	none	none	3594	8-10
RaCon516MI_0...00ST	Pushbutton	2	2	2	none	4253	8-10
RaCon516MI_S...00ST	Pushbutton	2	2	2	V2;V3	4682	8-10
RaCon516SP_0...00ST	Joysticks	2	2	2	none	6842	8-10
RaCon516SP_S...00ST	Joysticks	2	2	2	V2;V3	7141	8-10

Tandem systems for two cranes

RaCon516MI_0...T1ST	Pushbutton	2	2	2	none	9621	8-10
RaCon516SP_0...T1ST	Joysticks	2	2	2	none	13663	8-10

Spare transmitter (when purchased with new system - add 40% to radio list price)	+ 0.40 x list price	
--	----------------------------	--

Included:

- | | |
|---|---|
| <p>2 = Two-speed
 V2 = 2 position selection (1 or 2)
 V3 = 3 position selection (1, 1+2, 2)</p> | <p>Main contactor On-button
 Emergency Stop
 Key Switch
 Transmitter with battery and backup battery
 Receiver & connection cable with ready-to-go plugs
 Battery charger</p> |
|---|---|

R&M Materials Handling, Inc.
 4501 Gateway Blvd.
 Springfield, OH 45502



www.rmhoist.com

List prices FOB factory, Springfield, Ohio,
 subject to change without notice.
 Phone: 937-328-5100 Fax: 937-325-5319

Currency: CAD
Units: METRIC
Frequency: 60 Hz

QX / QL Crane Components

CRANE COMPONENT OPTIONS PRICING

Page 26
March 2, 2009

	Note	Code	Lead Time (weeks)	List Price
Thermal protection for bridge motor	B,C	BM08	8-10	428
IP66 Protection for bridge motor	C	BM09	8-10	428
Class H insulation for bridge motor	C	BM11	8-10	364
Manual release for bridge motor brake	B,C	BRA06	8-10	284
Magnetic limit switch for bridge		BT10	8-10	853
Photo detector anti-collision device for an existing crane	B,G	BT20	2-4	1046
Ultrasonic sensors anti-collision device for an existing crane	B,G	BT20	8-10	3696
Rubber cables for hoist power supply (% of standard festoon package)		CBL07	8-10	+ 28%
Cable tray component package		CBL08	8-10	966
Bumper extensions for bridge end trucks (One pair)		DES44	8-10	1554
Insulation for bridge panel	B,G	EL23	8-10	Use QuoteMaster
Thermostat controlled heating	B,G	EL24	8-10	Use QuoteMaster
Bridge panel light - operated by door	G	EL25	8-10	1028
Bridge panel light - manually operated	G	EL25	8-10	811
Rain cover for bridge panel	G	EL26	8-10	382
Cooling device per bridge panel - AC - Air conditioner	B,G	EL29	8-10	12968
Cooling device per bridge panel - CE - Cooling element	B,G	EL29	8-10	4158
Cooling device per bridge panel - CH - Air channel	B,G	EL29	8-10	9883
Cooling device per bridge panel - CHF - Air channel with filter	B,G	EL29	8-10	11900
Horn DBA 108		ELE05	2-4	379
All electrics in bridge panel	B,G	ELE10	8-10	Use QuoteMaster
Plug-in connector for pendant cable		ELE16	2-4	N.C.
Non-standard voltage/frequency for crane package	B	ELE21	8-10	713
Pliotex type wire marker		ELE48	8-10	435
Provision for crane lights (Price/light, 6 lights max./crane)	B,G	ELE61	8-10	557

Note A: List price = Regular list price x 1.65

Note B: Refer to hoist technical guide for details/restrictions

Note C: Per motor

Note D: Contact factory

Note E: Add HoistMonitor HS11 to hoist

Note F: Add HoistMonitor Elite HS13 to each hoist

Note G: Not available for chain hoist cranes

Note H: Price per direction



R&M Materials Handling, Inc.
4501 Gateway Blvd.
Springfield, OH 45502

www.rmhoist.com

List prices FOB factory, Springfield, Ohio,
subject to change without notice.

Phone: 937-328-5100 Fax: 937-325-5319

Currency: CAD
 Units: METRIC
 Frequency: 60 Hz

QX / QL Crane Components

CRANE COMPONENT OPTIONS PRICING

Page 27
 March 2, 2009

	Note	Code	Lead Time (weeks)	List Price
Hoist operated limit switch that trips mainline contactor	B,G	ELE64	8-10	606
Warning indication for traveling movement		ELE98	---	---
Flashing light - activated through crane traveling			2-4	382
Flashing light - activated through crane/trolley traveling			2-4	382
Flashing light - activated through trolley traveling			2-4	382
Warning sound - activated through crane traveling			2-4	382
Warning sound - activated through crane/trolley traveling			2-4	382
Warning sound - activated through trolley traveling			2-4	382
Flashing Light/Warning sound - activated through crane traveling			2-4	470
Flashing Light/Warning sound - activated through crane/trolley traveling			2-4	470
Flashing Light/Warning sound - activated through trolley traveling			2-4	470
Special lubrication for gears	B	GE21	8-10	140
One-step bridge travel limit switch (Slowdown)		LIM10	2-4	STD
One-step bridge travel limit switch (Stop)		LIM11	2-4	95
Two-step bridge travel limit switch (Slowdown+stop)		LIM12	2-4	626
Standby heater for bridge motor	C	MOT17	8-10	512
Rain cover for bridge motor	C,G	MOT18	8-10	189
Photo detector anti-collision device	B,G,H	OTH08	---	---
Stop operation - for one direction			2-4	1046
Slowdown operation - for one direction			2-4	1046
Slowdown & stop operation - for one direction			2-4	2093
Ultrasonic sensors anti-collision device	B,G,H	OTH08	---	---
Stop operation - for one direction			8-10	3696
Slowdown operation - for one direction			8-10	3696
Slowdown & stop operation - for one direction			8-10	7392

Note A: List price = Regular list price x 1.65

Note B: Refer to hoist technical guide for details/restrictions

Note C: Per motor

Note D: Contact factory

Note E: Add HoistMonitor HS11 to hoist

Note F: Add HoistMonitor Elite HS13 to each hoist

Note G: Not available for QL chain hoist cranes

Note H: Price per direction



R&M Materials Handling, Inc.
 4501 Gateway Blvd.
 Springfield, OH 45502

www.rmhoist.com

List prices FOB factory, Springfield, Ohio,
 subject to change without notice.

Phone: 937-328-5100 Fax: 937-325-5319

Currency: CAD
 Units: METRIC
 Frequency: 60 Hz

QX / QL Crane Components

CRANE COMPONENT OPTIONS PRICING

Page 28
 March 2, 2009

	Note	Code	Lead Time (weeks)	List Price
Plug kit + pigtail for radio controls (By others)			2-4	183
Plug kit for radio controls (By others)			2-4	74
Rail sweeps - wood (Price per end truck)	B	OTH21	8-10	1110
Rail sweeps - steel (Price per end truck)	B	OTH21	8-10	3483
Storm locks (Price per end truck)	B	OTH22	8-10	1774
Anti-jump catches for end truck (Price per end truck)	B	OTH24	8-10	963
Patented track wheels for end truck (Price per 8 wheels)		OTH26	2-4	1896
Crane number sticker		OTH28	2-4	95
Crane data plate		OTH30	2-4	133
Steel wheels for under running end trucks (Price per 8 wheels)			8-10	1637
IP55 stainless steel bridge panel adder (% of std bridge panel price)	A,B,G	PAN04	8-10	+ 45%
IP66 protection rating for stainless steel bridge panel	A,B,G	PAN07	8-10	+ 65%
Standby heater for bridge panel	G	PAN08	8-10	304
Plug source in bridge panel (1pc, 115v, 16A) - less plug outlet	G	PAN17	8-10	2275
Standby heater for pendant	G	PEN03	8-10	189
Contactoer bridge control (Two-speed)		PRI01	8-10	1175
Longer chain for trolley tow arm		PS05	2-4	95

Note A: List price = Regular list price x 1.65

Note B: Refer to hoist technical guide for details/restrictions

Note C: Per motor

Note D: Contact factory

Note E: Add HoistMonitor HS11 to hoist

Note F: Add HoistMonitor Elite HS13 to each hoist

Note G: Not available for QL chain hoist cranes

Note H: Price per direction

R&M Materials Handling, Inc.
 4501 Gateway Blvd.
 Springfield, OH 45502



www.rmhoist.com

List prices FOB factory, Springfield, Ohio,
 subject to change without notice.

Phone: 937-328-5100 Fax: 937-325-5319

Currency: CAD
 Units: METRIC
 Frequency: 60 Hz

QX / QL Crane Components

Page 29
 March 2, 2009

SPARE PARTS KIT PRICING

Spare Parts Packages for Bridge Panels

Hoisting Motor Size	List Price
P1, P2, P3	581
P4	641
P5, P6	886
P7	1160
P8	1649

Spare part package for the bridge panel include:
 - Mainline contactor and fuses

Spare Parts Packages for Traveling Drives

Motor Size	List Price
MF06 (with DC brake)	488
MF07	488

Spare part package for the drives include:
 - D.C. brake repair set - 2 pcs
 - D.C. brake rectifier - 2 pcs

Spare Parts Packages - Traveling Inverters

Inverter Size	List Price
CMXC 007	795
CMXC 022	1100
CM Select 002	2824
CM Select 003	3562
CM Select 004	4298

Spare Parts Packages for Traveling Drives

Motor Size	List Price
MF06 (with Compact brake)	183

Spare part package for the drives include:
 - Friction disc kit

Prices are valid only when purchased with a components package.

Additional discounting beyond your standard R&M discount is not available on spare parts kits.

R&M Materials Handling, Inc.
 4501 Gateway Blvd.
 Springfield, OH 45502



www.rmhoist.com

List prices FOB factory, Springfield, Ohio,
 subject to change without notice.

Phone: 937-328-5100 Fax: 937-325-5319