

TECHNICAL TIP - TRAVEL GEARBOX BREATHING HOLE

When orienting gearboxes for travel motion, care should be taken to determine if the pin in the breathing plug should be removed or not. Hole must be above level of oil.

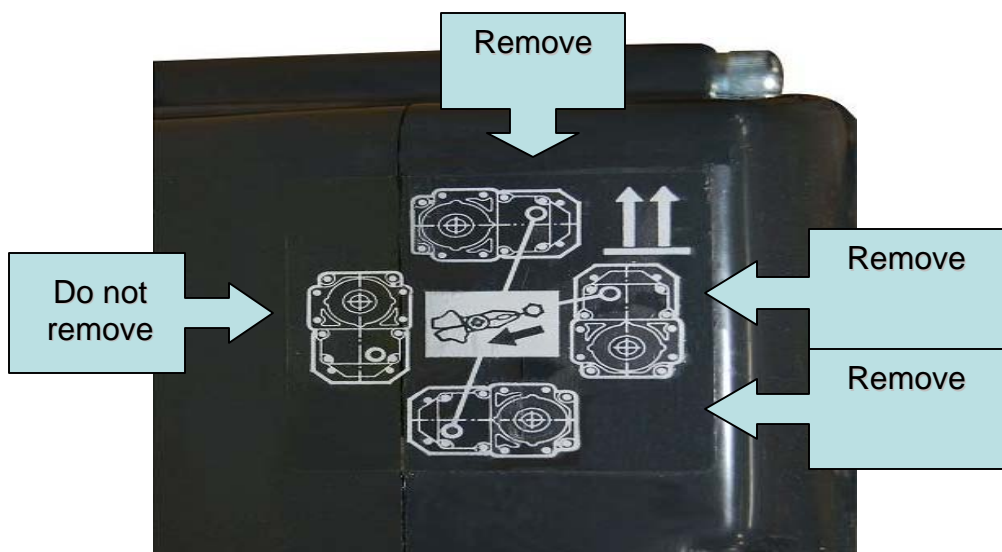

The photo below shows the legend on a typical gearbox. The small pliers' symbol shows what orientation the pin should be removed on.



Innovation...Performance...Reliability